

# PINZE SENZA LAVORAZIONE DEL VETRO

## CLAMPS WITHOUT GLASS PREPARATION / KLEMMSCHUHE OHNE GLASBEARBEITUNG

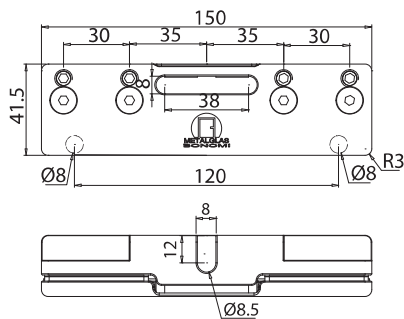

Materiale: **ALLUMINIO PRESSOFUSO**  
Material: **DIE CASTED ALUMINIUM**  
Material: **GEGOSSENES ALUMINIUM**



### V-108

- Pinza rivoluzionaria che permette in economia grazie ai suoi kit di spessori, compresi, di serrare vetri dal 8 al 12,76 mm. Inoltre grazie ai grani si possono anche serrare vetri con misure variabili, esempio 12,5 - 10,3 - 8,6 mm
- Trail-blazing clamp complete with spacers to tighten 8 to 12.76 mm glass in a cost-effective manner.
- Moreover, the dowels allow tightening glass of variable sizes, for example 12.5 - 10.3 - 8.6
- Revolutionärer Klemmschuh, der es dank den mitgelieferten Unterlage-Kits möglich macht, wirtschaftlich Gläser von 8 bis 12,76 mm zu klemmen. Zudem können dank der Gewindestifte auch Gläser mit variablen Maßen geklemmt werden, zum Beispiel 12,5 – 10,3 – 8,6

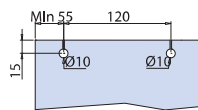
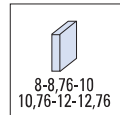

**OPTIONAL**  
**Fori di sicurezza**  
**Security holes**  
**Sicherheitsbohrungen**

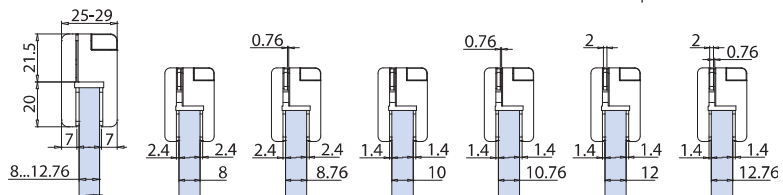

- Spessori inclusi
- Spacers included
- Distanzscheiben enthalten
- Grani per garantire un serraggio ottimale
- Extra screws for a optimal fastening
- Extra Schrauben für ein optimales Anziehen

€ A.589

xme526



Materiale: **ALLUMINIO TRAFILATO**  
Material: **EXTRUDED ALUMINIUM**  
Material: **STRANGEPRESSTES ALUMINIUM**

### V-104

- Pinza realizzata principalmente per controtelai a scomparsa, raso parete senza stipiti con le sue velette senza lavorazione del vetro di dimensioni ridotte
- Clamp made to be used mainly with flush pocket systems without frames, with cover profiles, without glass preparation, of limited dimensions
- Klemmschuh, der hauptsächlich für Einbaukastenrahmensysteme hergestellt worden ist, bündig an Wänden ohne Zargen, mit Abdeckblenden, ohne Glasbearbeitung und mit kleinen Abmessungen

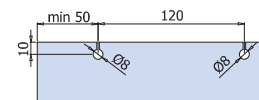
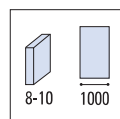
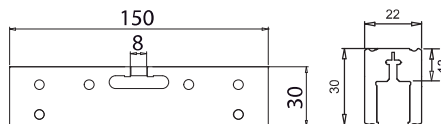

**OPTIONAL**  
**Fori di sicurezza**  
**Security holes**  
**Sicherheitsbohrungen**

€ A.590

xla39



Materiale: **ALLUMINIO PRESSOFUSO**  
Material: **DIE CASTED ALUMINIUM**  
Material: **GEGOSSENES ALUMINIUM**

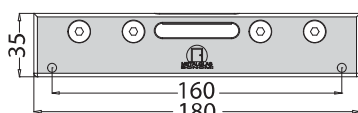

### V-090

- Pinza
- Clamp
- Klemmschuh

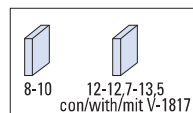
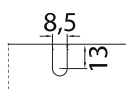
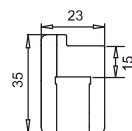

€ A.591

### V-1817

- Kit spessori per vetro 12-12,7-13,5 - per 2 pinze V-090 e V-090-T
- Kit spacers for glass thickness 12-12,7-13,5 - for 2 clamps V-090 and V-090-T
- Kit Distanzscheiben für Glasdicke 12-12,7-13,5 - für 2 Klemm-Lauwagen V-090 und V-090-T

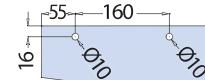
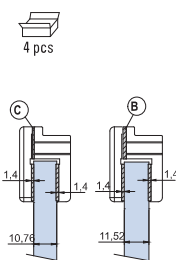
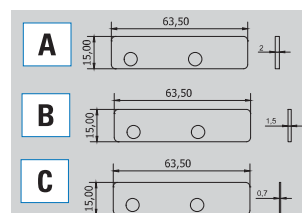

**OPTIONAL**  
**Fori di sicurezza**  
**Security holes**  
**Sicherheitsbohrungen**

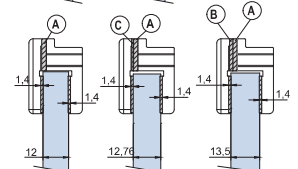

€ A.592



50 Kg  
x 2pcs

Materiale: **ALLUMINIO PRESSOFUSO**  
 Material: **DIE CASTED ALUMINIUM**  
 Material: **GEGOSSENES ALUMINIUM**

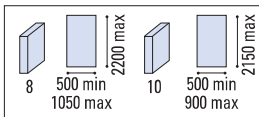

### V-1845

€▶A.593

- Pinza innovativa senza lavorazione vetro: la più piccola al mondo con i suoi 25 mm di altezza, (la prima vera alternativa alle pinze con lavorazione del vetro per porte a scomparsa).
- Trail-blazing clamp without glass preparation: with a height of 25 mm, it is the smallest in the world (and the first real alternative to clamps with glass preparation for flush sliding doors).
- Innovativer Klemmschuh ohne Glasbearbeitung: der weltweit kleinste mit 25 mm Höhe, (die erste wirkliche Alternative zu Klemmschuhen mit Glasbearbeitung für Einbauschiebetüren).

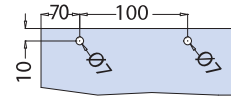
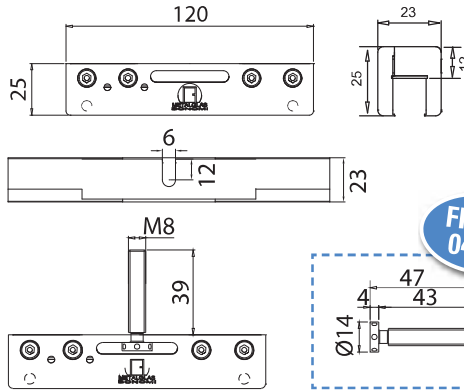

**OPTIONAL**  
 Fori di sicurezza.  
 Raccomandati per peso ante > 40 kg  
**Security holes.**  
 Recommended for weight panels > 40 kg  
**Sicherheitsbohrungen.**  
 Empfohlen mit Flügelgewicht > 40 kg

xme510a

## PINZE CON LAVORAZIONE DEL VETRO CLAMPS WITH GLASS PREPARATION / KLEMMSCHUHE MIT GLASBEARBEITUNG



### V-011-FU

Materiale: **ALLUMINIO PRESSOFUSO**  
 Material: **DIE CASTED ALUMINIUM**  
 Material: **GEGOSSENES ALUMINIUM**

- Pinza per scorrevole in fusione di alluminio vetro 8/10 mm con fori nel vetro verniciata grigia
- Die casted clamp for glass sliding door 8/10 mm with glass preparation silver lacquered
- Klemmschuh gegossen für Ganzglasschiebetür 8/10 mm Glasdicke mit Glasbohrung, silber lackiert

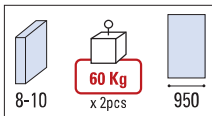

€▶A.594

### V-011-FR

Materiale: **ALLUMINIO TRAFILATO**  
 Material: **EXTRUDED ALUMINIUM**  
 Material: **STRANGEPRESSTES ALUMINIUM**

- Pinza per scorrevole ricavata da materiale pieno, vetro 8/10 mm con fori nel vetro alluminio anodizzato
- Clamp for glass sliding door 8/10 mm with glass preparation aluminium anodised
- Klemmschuh für Ganzglasschiebetür 8/10 mm Glasdicke mit Glasbohrung, EV1

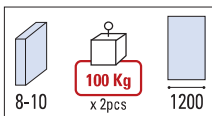

€▶A.595

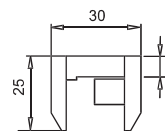
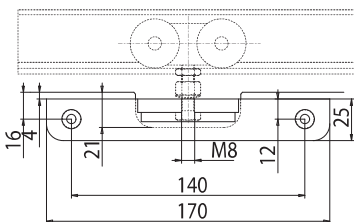
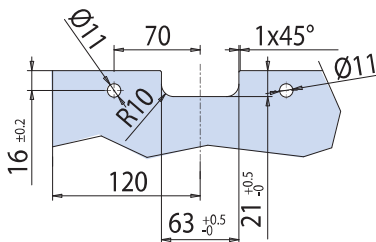

xla39



120 Kg  
x 2pcs

Materiale: **ALLUMINIO TRAFILATO**  
 Material: **EXTRUDED ALUMINIUM**  
 Material: **STRANGEPRESSTES ALUMINIUM**

### V-010

€▶A.600

- Pinza per scorrevole vetro 8/10 mm senza fori
- Clamp for sliding door 8/10 mm without holes
- Klemmschuh für Ganzglasschiebetür 8/10 mm ohne Glasbearbeitung (Bohrungen, Fräsungen)

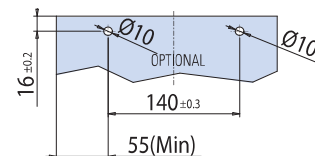
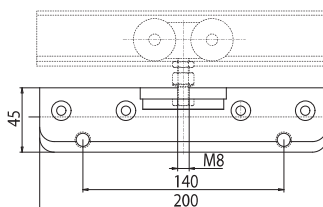
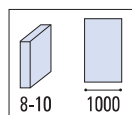

**OPTIONAL**  
 Fori di sicurezza  
**Security holes**  
**Sicherheitsbohrungen**

xla39



80 Kg  
x 2pcs

Materiale: **ZAMA**  
Material: **ZAMAK**  
Material: **ZAMAK**

### V-006

- Come la V-011, pinza adatta per porte a scomparsa con controtelai standard. Grazie alla sua innovativa lavorazione del vetro basta fare solo una tacca nel vetro al posto della tacca più fori della V-011
- Like the V-011, this clamp is suitable for flush sliding doors with standard pocket systems. Thanks to its innovative glass preparation, you only need one notch in the glass instead of the notch plus holes needed with the V-011
- Wie der V-011, ist der Klemmschuh für Einbauschiebetüren mit Standard-Kastenrahmen geeignet. Dank der innovativen Glasbearbeitung reicht nur eine Kerbe im Glas aus, im Gegensatz zum V-011, wo eine Kerbe plus Bohrungen notwendig sind

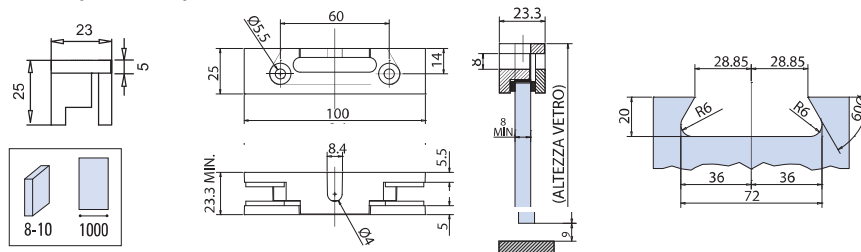

€▶ A.596



Materiale: **ZAMA**  
Material: **ZAMAK**  
Material: **ZAMAK**

### V-007

- Paio copertine optional per pinza V-006
- Pair optional covers for clamp V-006
- Paar optional Abdeckungen für Klemmschuh V-006  
CP - NS

€▶ A.597



100 Kg  
x 2pcs

Materiale: **ALLUMINIO TRAFILATO**  
Material: **EXTRUDED ALUMINIUM**  
Material: **STRANGEPRESSTES ALUMINIUM**

### V-009

- Pinza per scorrevole vetro 8/10 mm senza fori nel vetro
- Clamp for glass sliding door 8/10 mm without holes
- Klemmschuh für Schiebetür 8-10mm, ohne Bohrungen

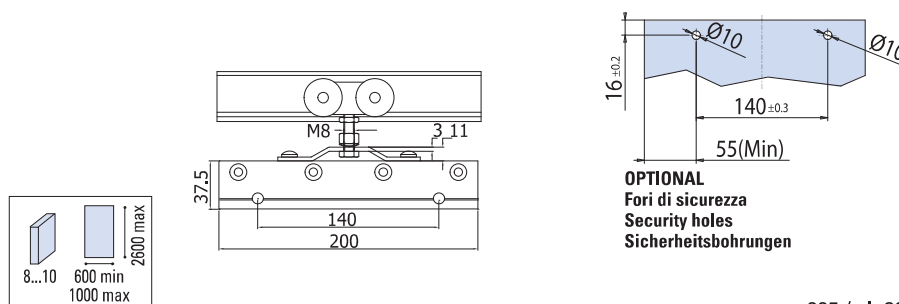

€▶ A.599

xme335 / xla39



100 Kg  
x 2pcs

Materiale: **ALLUMINIO TRAFILATO**  
Material: **EXTRUDED ALUMINIUM**  
Material: **STRANGEPRESSTES ALUMINIUM**

### V-008

- Pinza per scorrevole vetro 8/10 mm senza fori nel vetro
- Clamp for glass sliding door 8/10 mm without glass preparation
- Klemmschuh für Schiebetür 8-10mm, ohne Bohrungen

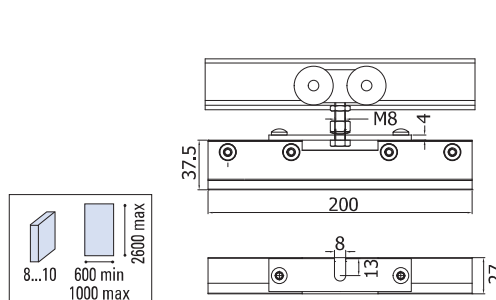

€▶ A.598

xme335

## NICCHIE PER SCORREVOLI SLIDING HANDLES / GRIFFMUSCHELN



### V-506

- Paio nicchie scorrevoli Minima senza viti in vista
  - Pair sliding door-handles Minima without visible screws
  - Paar Griffmuscheln Minima ohne sichtbare Schrauben
- CS - NS - CR - CP - GR

€▶ A.607

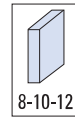
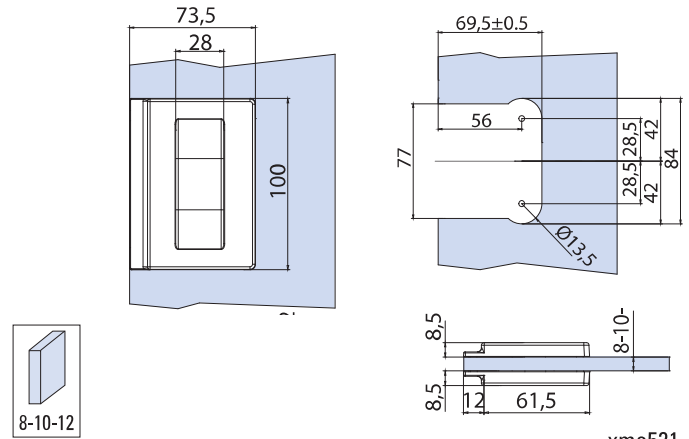

xme521



### V-406

- Paio nicchie scorrevoli con tirante.
  - Pair sliding handles with pull-lever.
  - Paar Griffmuscheln mit stirnseitigem Griff.
- NS - CR - CP

€▶ A.608

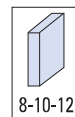
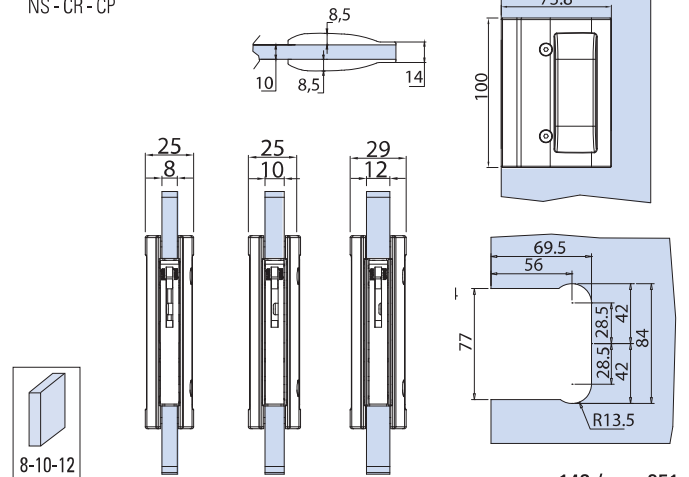

xme143 / xme351



### V-406-R

- Paio nicchie per porte scorrevoli a scomparsa con tirante. Frontale ribassato spessore 15 mm. Spessore totale nicchia 20 mm
  - Pair sliding handles with flush lever for pocket doors. Frontal thickness 15 mm. Handle total thickness 20 mm
  - Paar Griffmuscheln mit stirnseitigem Griff für Kastenrahmensysteme. Stärke Vorderseite 15 mm, Gesamtstärke 20 mm
- AN - NS - GR

€▶ A.609

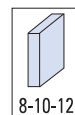
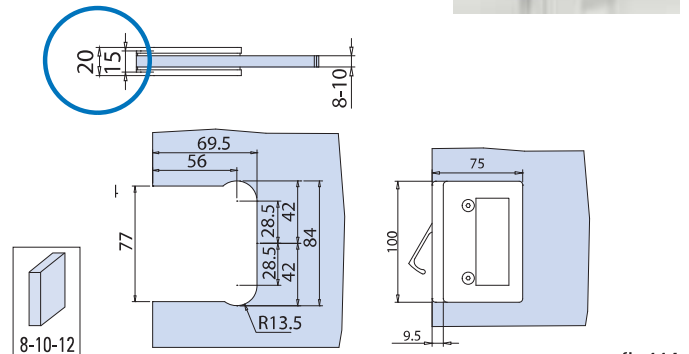

xfb-114

# V-404

SERRATURA PER SCORREVOLI CON TIRANTE / LOCKS WITH FLUSH PULL FOR SLIDING /  
DOORS SCHLÖSSER FÜR SCHIEBETÜREN MIT STIRNSEITIGEM GRIFF

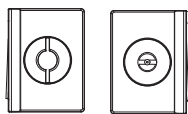

### V-404 PO-WC

- Leva
- WC apertura emergenza
- Lever
- WC emergency open
- Griff
- WC Notöffnung

€ E.260

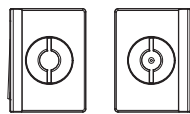

### V-404 PO-PO

- Leva
- Leva
- Lever
- Lever
- Griff
- Griff

€ E. 261

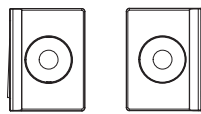

### V-404 2FLG

- Tappo cieco
- Blind
- Blind
- Tappo cieco
- Blind
- Blind

€ E.264

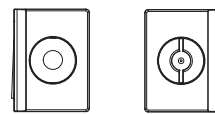

### V-404 PO-2FLG

- Tappo cieco
- Blind
- Blind
- Leva
- Lever
- Griff

€ E.263

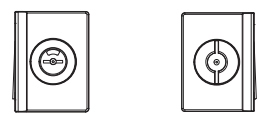

### V-404 WC COLOUR

- Indicatore colorato
- Coloured indicator
- Schliessanzeige
- Leva
- Lever
- Griff

€ E.262

- Scorrevole a scomparsa (solo vetro 8 mm)
- Pocket doors (only 8 mm)
- Schiebetüren in der Wand laufend (nur 8 mm Glas)
- Contropiastra inclusa
- Strike plate included
- Schließblech im Set enthalten

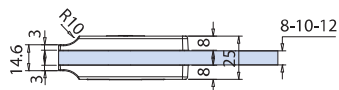
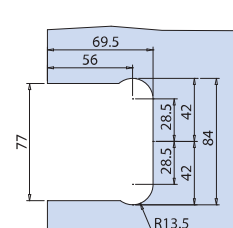
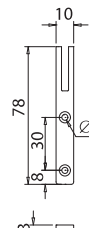
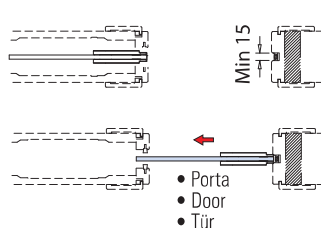
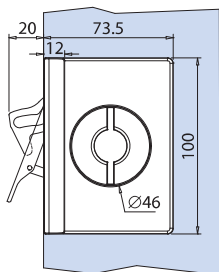

**CP**  
Cromo perla  
Chrome perla similar Alu  
Chrom perla ähnlich Alu

**NS**  
Nickel satinato  
Satin nickel Ähnlich  
Edelstahl matt

**CR**  
Cromo lucido  
Polished chrome  
Chrom glänzend

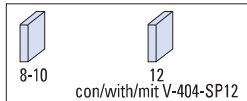

### V-404 WC COLOUR

- Serratura per scorrevoli con tirante e indicatore colorato "libero/occupato"
- Locks with flush pull for sliding doors with WC latch and coloured indicator
- Schlösser für Schiebetüren mit stirnseitigem Griff, und WC Schliessanzeige

xfb053

163



**V-522**

- Paio nicchie quadre per scorrevole
- Pair sliding door-handles square
- Paar eckige Griffmuscheln

AN - NS - CR

€▶A.610

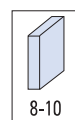
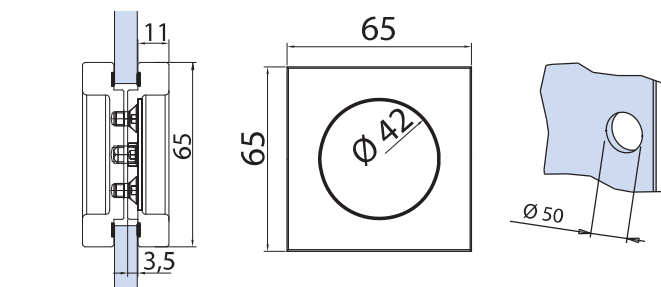

xme015



**V-522-INC**

- Nicchia quadra per scorrevole ad incollaggio biadesivo
- Sliding door-handle square, with self adhesive fixing
- Eckige griffmuschel, selbstklebend

AN - NS

€▶A.611

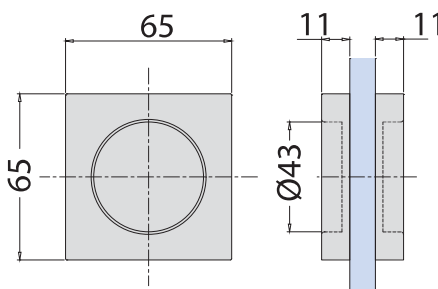

1 pcs

xfb-nicchie ad incollaggio



**V-533-INC**

- Nicchia quadra per scorrevole ad incollaggio biadesivo
- Sliding door-handle square, with self adhesive fixing
- Eckige griffmuschel, selbstklebend

AN - NS

€▶A.612

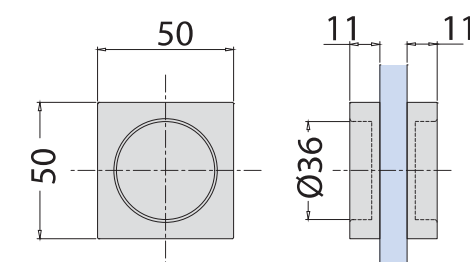

1 pcs

xfb-nicchie ad incollaggio

**V-511**

- Paio nicchie scorrevole senza viti a vista
- Pair sliding door handles with invisible fixing screws
- Paar Griffmuscheln mit nicht sichtbaren Schrauben

CS - NS - CR - CP - NO

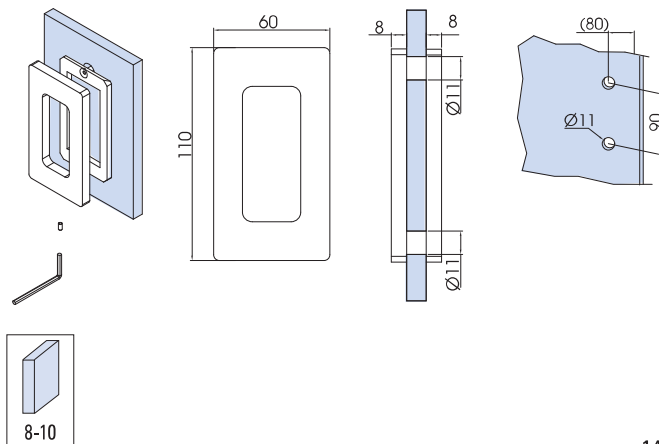

€►A.614

**V-534-INC**

- Nicchia scorrevole ad incollaggio biadesivo
- Sliding door-handle with self adhesive fixing
- Griffmuschel Gröss selbstklebend

CS - NS - CR - OL

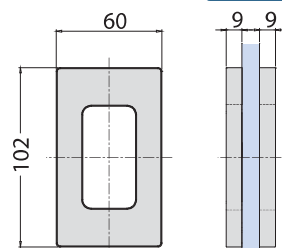

€►A.616

**V-511-INC**

- Nicchia scorrevole ad incollaggio biadesivo
- Sliding door-handle with self adhesive fixing
- Griffmuschel Gröss selbstklebend

OL

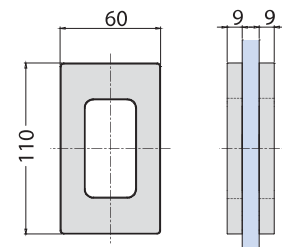

€►A.615

xfb-nicchie ad incollaggio

**V-510**

- Paio nicchie per scorrevole senza viti a vista
- Pair sliding door handles with invisible fixing screws
- Paar Griffmuscheln mit nicht sichtbaren Schrauben

CS - NS - CR - CP

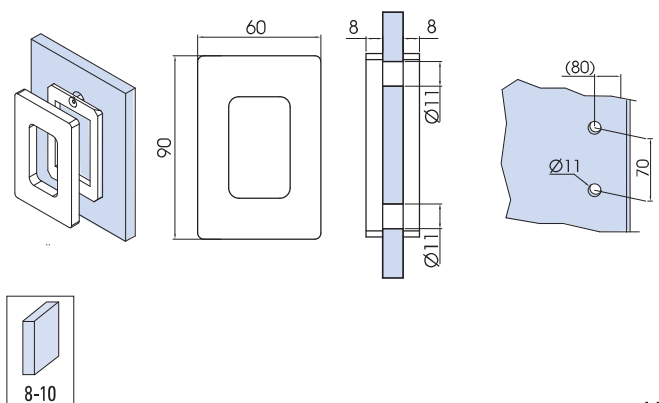

€►A.613

1 pcs

8-10

xme144

165



**V-512**

- Paio nicchie per scorrevole tonde, Ø 65.
  - Pair sliding door-handles, Ø 65
  - Paar Griffmuscheln, Ø 65
- AN - CS - NS - CR - OL - NO

€▶A.619

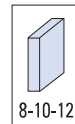
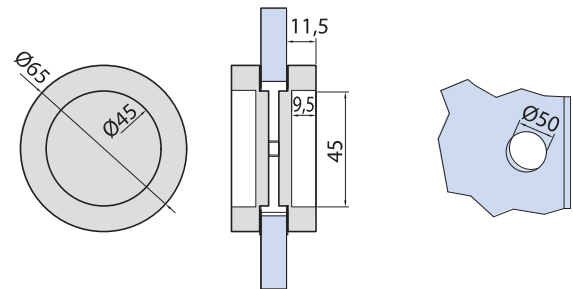

xme050



**V-524-08** (per vetro / for glass / für Glas 8 mm)  
**V-524-10** (per vetro / for glass / für Glas 10 mm)

- Paio nicchie per scorrevole tonde, Ø 60
  - Pair sliding door-handles, Ø 60
  - Paar Griffmuscheln, Ø 60
- AN - NS - CR

€▶A.621

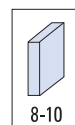
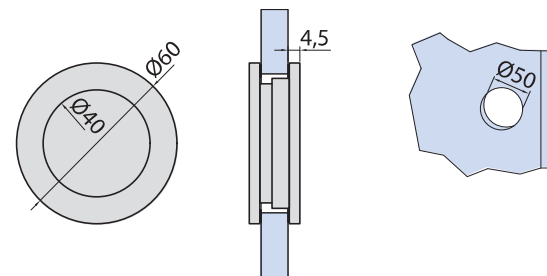

xme050



**V-523**

- Paio nicchie per scorrevole tonde, Ø 55
  - Pair sliding door-handles, Ø 55
  - Paar Griffmuscheln, Ø 55
- AN - NS - CR

€▶A.620

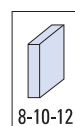
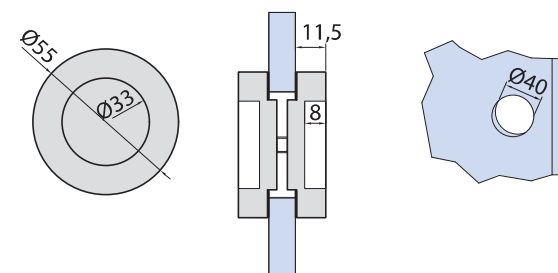

xme050





1 pcs

### V-512-INC

- Nicchia tonda ad incollaggio per scorrevole Ø 64 - H 11
- Sliding door-handle round Ø 64 - H 11 with self adhesive
- Griffmuschel, Ø 64 - H 11 selbstklebend AN - NS

€▶A.619

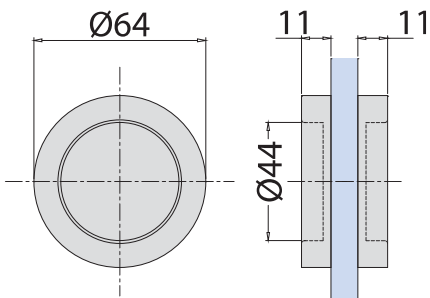

xfb-nicchie ad incollaggio



1 pcs

### V-532-INC

- Nicchia scorrevole ad incollaggio biadesivo Ø 50
- Sliding door-handle with self adhesive Ø 50
- Griffmuschel selbstklebend AN - NS

€▶A.617

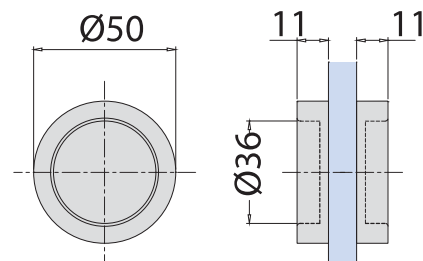

xfb-nicchie ad incollaggio



### V-526

- Paio nicchie chiuse Ø 40
- Pair closed sliding-handles Ø 40
- Paar Griffmuscheln Ø 40 geschlossen AN - NS - CR

€▶A.623

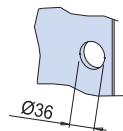
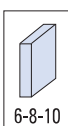
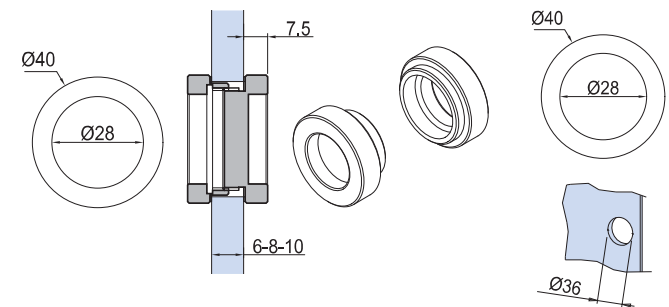

xme090



**V-525**

- Paio nicchie aperte Ø 40
  - Pair open sliding-handles Ø 40
  - Paar Griffmuscheln Ø 40 mit Glasdurchgriff
- AN - NS - CR

€▶ A.622

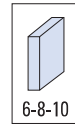
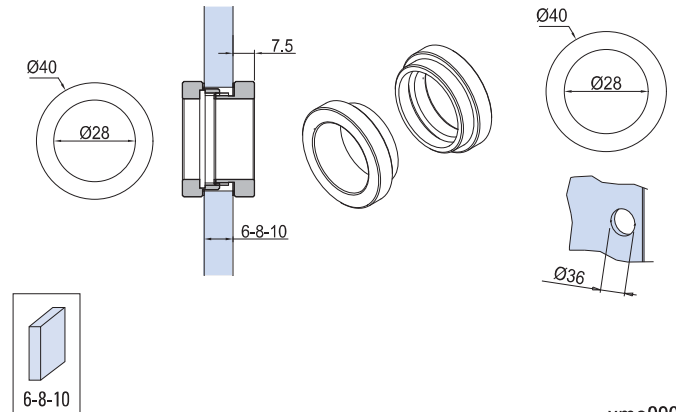

xme090



**V-527**

- Paio nicchie aperte Ø 30
  - Pair open sliding-handles Ø 30
  - Paar Griffmuscheln Ø 30 mit Glasdurchgriff
- AN - NS - CR

€▶ A.624

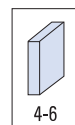
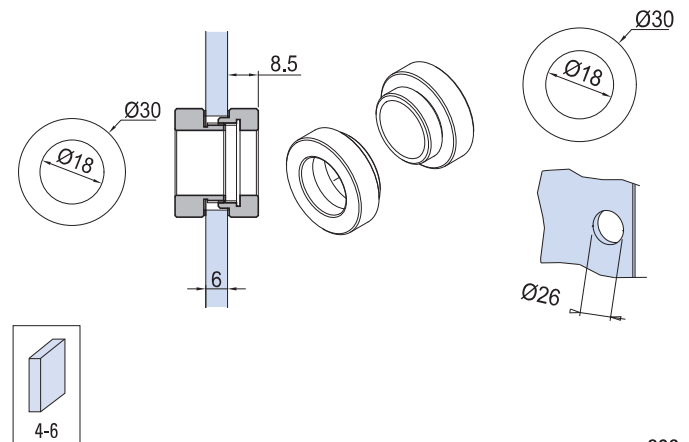

xme090



**V-528**

- Paio nicchie chiuse Ø 30
  - Pair closed sliding-handles Ø 30
  - Paar Griffmuscheln Ø 30 geschlossen
- AN - NS - CR

€▶ A.625

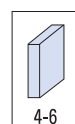
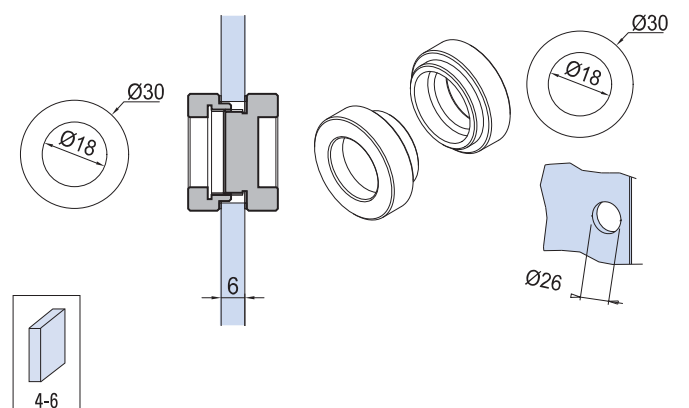

xme090



1 pcs

**B-179**

- Maniglia ad incollaggio biadesivo
- Small handle with self adhesive fixing
- Klein Griff selbstklebend

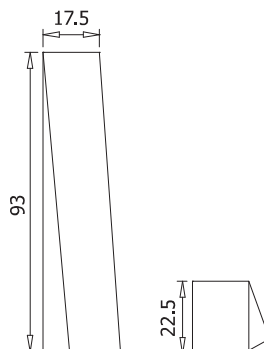
 ▶ **A.626**

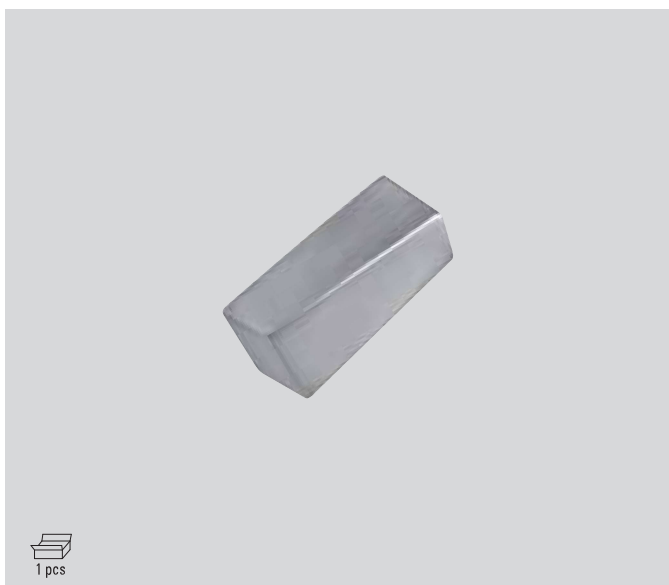

xme281



1 pcs

**B-180**

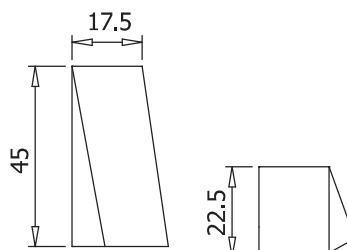
- Maniglia ad incollaggio biadesivo, versione corta
  - Small handle with self adhesive fixing
  - Klein Griff selbstklebend
- CS - CR

 ▶ **A.626**

xme281



**MANIGLIONI AD INCOLLAGGIO  
PULLHANDLES WITH  
SELF-ADHESIVE  
STOSSGRIFFE SELBSTKLEBEND**



**MANIGLIONI MINI  
PULLHANDLES MINI  
MINI STOSSGRIFFE  
Ø 15 - □ 15**



**MANIGLIONI  
PULLHANDLES  
STOSSGRIFFE  
Ø 20 - Ø 25 - Ø 30  
□ 19 - □ 25 - □ 40**



**MANIGLIONI CON SERRATURA  
PULLHANDLES WITH LOCK  
VERSPERBARER STOSSGRIFFE**

VEDI CATALOGO  
SEE CATALOGUE  
SIEHE KATALOG

▶ **INDOOR "F"**

## SERRATURE PER PORTE SCORREVOLI LOCKS FOR SLIDING DOORS / SCHLÖSSER FÜR SCHIEBETÜREN



### V-724 PZ ELEGANT

€ E.105

- Serrature Elegant con gancio per scorrevole.
  - Cilindri e contropiastre da ordinare a parte
  - Locks Elegant with Hook for sliding doors.
  - Cylinders and strike plates not included, to order separately
  - Elegant Schlösser mit Hakenriegel für Schiebetüren.
  - Zylinder und Schließbleche nicht enthalten, separat zu bestellen
- CS - NS - CR - CP

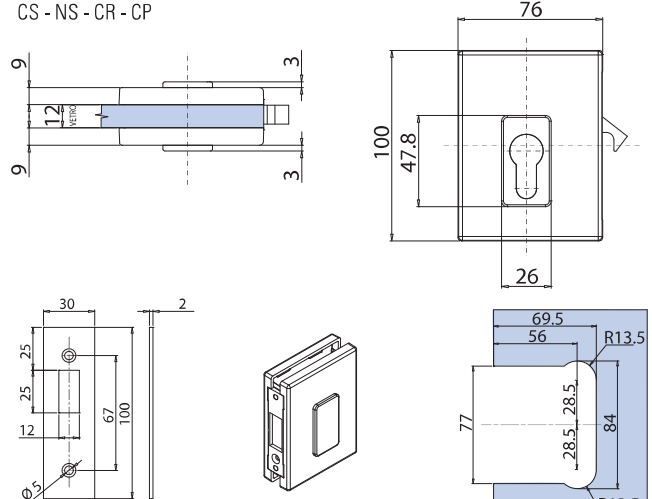

### V-022

### V-724 2FLG

### C-018

### C-06

### C-016

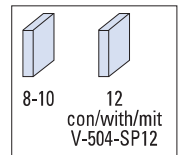
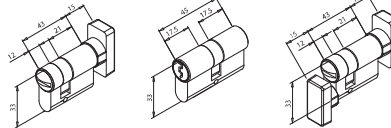

fb049-a-gr



### V-734 PZ ELEGANT DRAG

€ E.141

- Serrature Elegant Drag con gancio per scorrevole.
  - Cilindri e contropiastre da ordinare a parte
  - Locks Elegant Drag with Hook for sliding doors.
  - Cylinders and strike plates not included, to order separately
  - Elegant Drag Schlösser mit Hakenriegel für Schiebetüren.
  - Zylinder und Schließbleche nicht enthalten, separat zu bestellen
- CS - NS - CR - CP

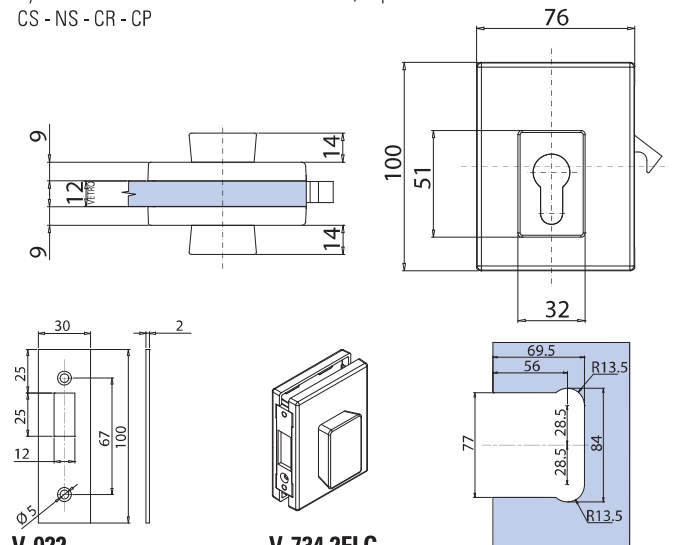

### V-022

### V-734 2FLG

### C-014

### C-013

### C-08-Q

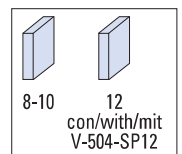
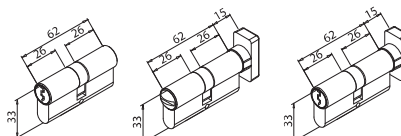

fb049-a-gr



**V-734 COLOR ELEGANT DRAG COLOR**

€ ▶ E.154

- Serrature Drag Color con gancio per scorrevole.
- Cilindri e contropiastre da ordinare a parte
- Locks Drag Color with Hook for sliding doors.
- Cylinders and strike plates not included, to order separately
- Drag Color Schlösser mit Hakenriegel für Schiebetüren.
- Zylinder und Schließbleche nicht enthalten, separat zu bestellen
- CS - NS - CR - CP

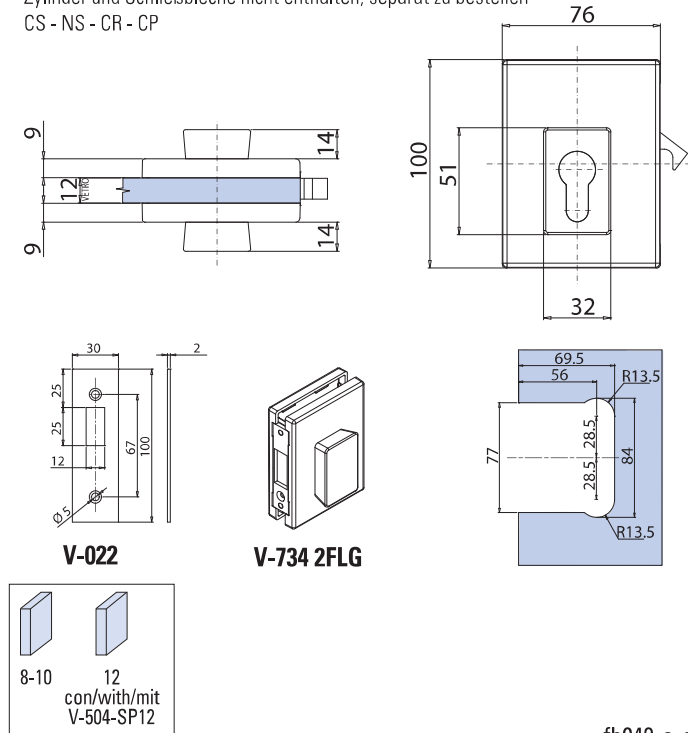

fb049-a-gr



**V-564 MINIMA 55**

€ ▶ E.195

- Serrature Minima 55 con gancio per scorrevole.
- Cilindri e contropiastre da ordinare a parte
- Locks Minima 55 with hook for sliding doors.
- Cylinders and strike plates not included, to order separately
- Minima 55 Schlösser mit Hakenriegel für Schiebetüren.
- Zylinder und Schließbleche nicht enthalten, separat zu bestellen
- NS - CR - CP

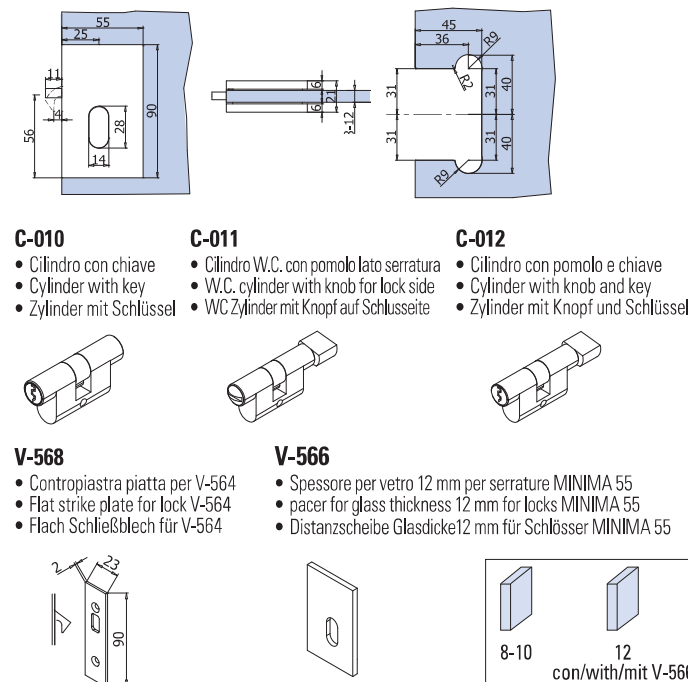

xme445



**V-564 MINIMA 55 COLOR**

€ E.205

- Serrature Minima 55 Color con gancio per scorrevole, indicatore WC colorato. Contropiastre da ordinare a parte
  - Locks Minima 55 Color with hook for sliding doors, with coloured indicator. Strike plates not included, to order separately
  - Minima 55 Color Schlösser mit Hakenriegel für Schiebetüren oder, mit Farbanzeige. Schließbleche nicht enthalten, separat zu bestellen
- NS - CR - CP

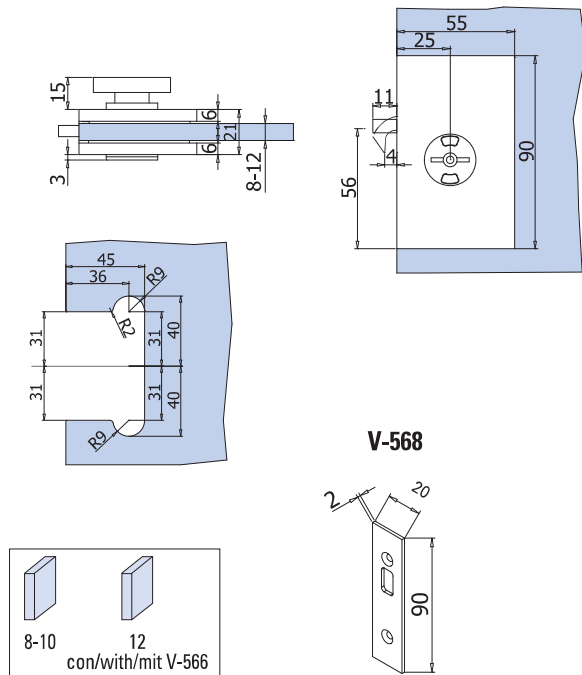

xme496



**V-594 MINIMA 55 DRAG COLOR**

€ E.229

- Serrature Minima 55 Drag Color con gancio per scorrevole, indicatore WC colorato. Contropiastre da ordinare a parte
  - Locks Minima 55 Drag Color with hook for sliding doors, with coloured indicator. Strike plates not included, to order separately
  - Minima 55 Drag Color Schlösser mit Hakenriegel für Schiebetüren, mit Farbanzeige. Schließbleche nicht enthalten, separat zu bestellen
- NS - CR - CP

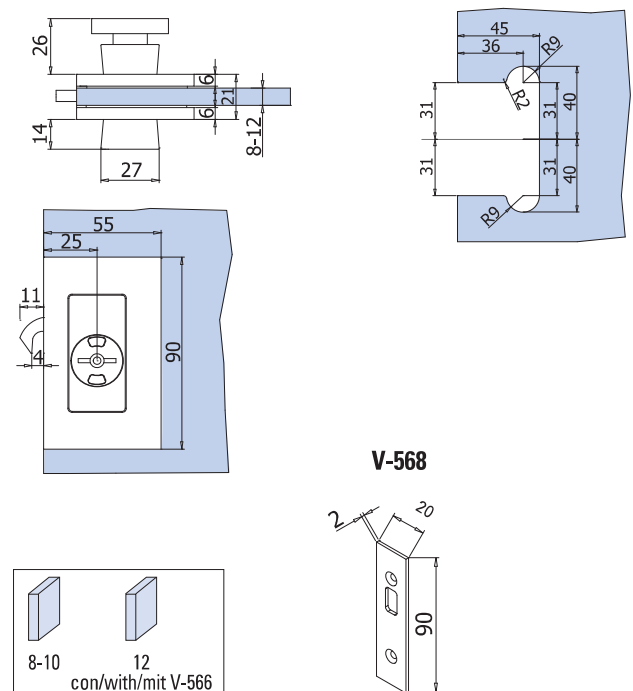

xme496



**V-504 2FLG**  
 • Controserratura  
 • Strike box  
 • Gegenkasten

**Minima V-504 NC**

€ ► E.164

- Serrature Minima con gancio per scorrevole. Cilindri e contropiastre da ordinare a parte
  - Locks Minima with Hook for sliding doors. Cylinders and strike plates not included, to order separately
  - Minima Schlösser mit Hakenriegel für Schiebetüren. Zylinder und Schließbleche nicht enthalten, separat zu bestellen
- NS - CS - CR - CP - OL - NO

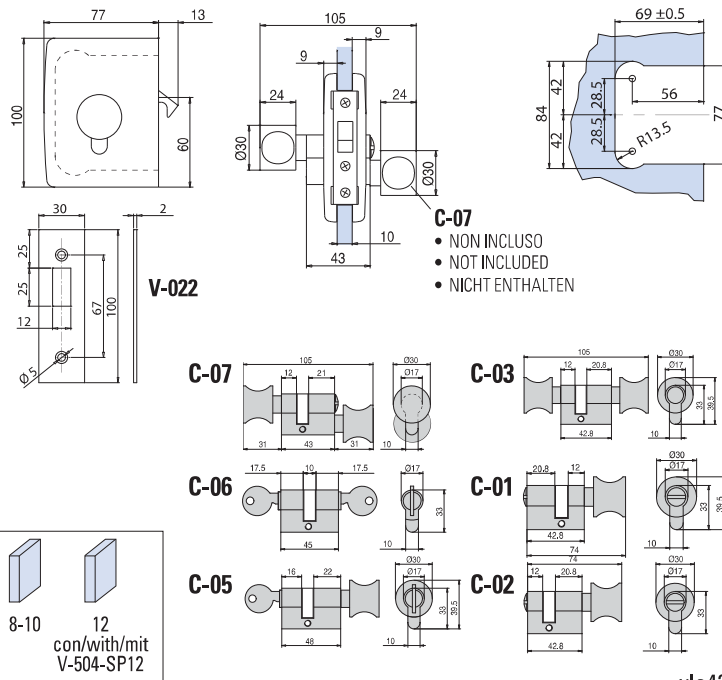

xla42



**V-529 / V-530**

€ ► E.193

- Controserratura montaggio a muro completo di contropiastra reversibile regolabile per serrature V-504 / V-518 / V-554 / V-734 / V-724
  - Wall installation strike box complete with adjustable plate for locks V-504 / V-518 / V-554 / V-734 / V-724
  - Gegenkasten für Wandmontage mit verstellbares Schießblech für Schlösser V-504 / V-518 / V-554 / V-734 / V-724
- NS - CS - CR - CP

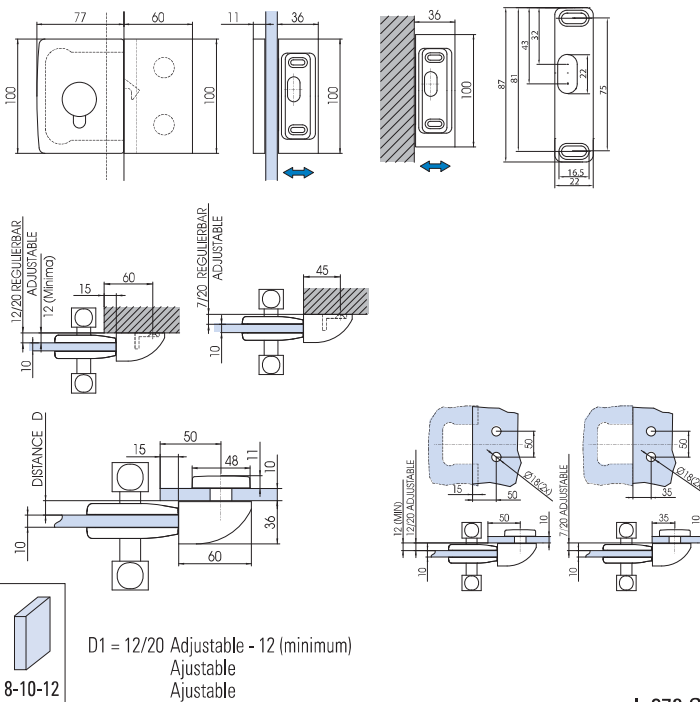

xla270 GER

## ACCESSORI PER SCORREVOLI ACCESSORIES FOR SLIDING DOORS / ZUBEHÖR FÜR SCHIEBETÜREN



### V-012-INS

- Guida a pavimento regolabile per vetro da 8 a 13,5 mm con piastrina di fissaggio a terra per un facile inserimento della guida ideale per scorrevoli invisibili e Telescopici
- Floor guide adjustable for glass from 8 to 13,5 mm. Perfect for Invisible and Telescopic
- Bodenführung verstellbar für Glas von 8 bis 13,5mm perfekt für invisible und Teleskop Schiebe-Systeme, dank der Befestigungsplatte einsetzbar

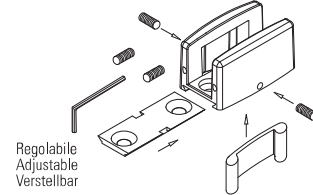
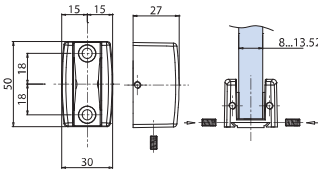
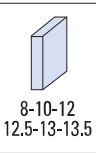

Regolabile  
Adjustable  
Verstellbar

€▶ A.630

FB059-A



### V-012-REG

- Guida a pavimento regolabile per vetro da 8 a 13,5 mm
- Floor guide adjustable for glass from 8 to 13,5 mm
- Bodenführung verstellbar für Glas von 8 bis 13,5mm

AN - NS - CR

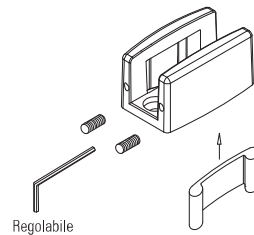
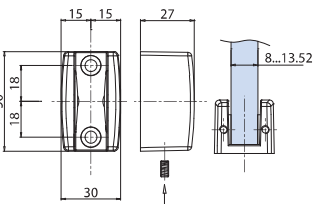
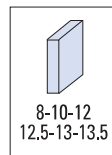

Regolabile  
Adjustable  
Verstellbar

€▶ A.629

FB059-A



### V-012-EVO

- Guida a pavimento regolabile per vetro 8-10-12 mm
- Floor guide adjustable for glass 8-10-12 mm
- Bodenführung verstellbar für Glas 8-10-12 mm

AN - NS - CR - NO

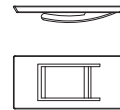
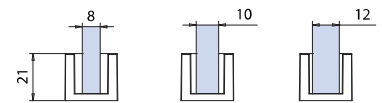
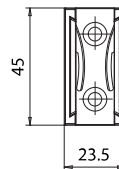
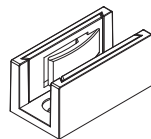
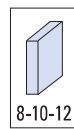

€▶ A.628

V-012NEW



### P-F08

- Guida a pavimento per pannello in legno
- Floor guide for sliding wooden panel
- Bodenführung für Schiebetüren aus Holz

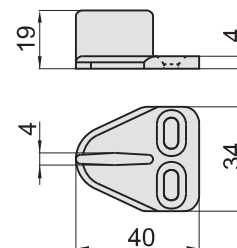

€▶ A.638

P-F08



### V-012

- Guida a pavimento per vetro 8/10 mm
- Floor guide with felt strips for glass sliding door a 8 and 10mm
- Bodenführung für Glas 8/10 mm

AN - NS - CR

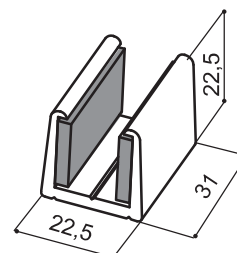
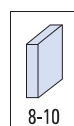

€▶ A.627

V-012



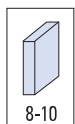

**V-014**

- Guida a pavimento per scorrevole regolabile 8/10 mm
- Floor guide adjustable 8/10 mm
- Bodenführung verstellbar für 8, 10 mm Glasdicke  
CS - NS - CR - OL - CP

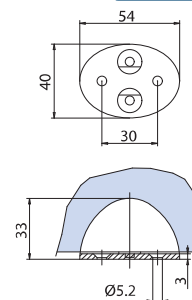
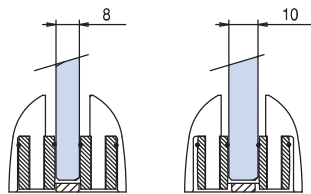

8-10



€▶A.632

xme022

**V-052**

- Guida a pavimento per vetro 8 e 10 mm. con feltrini
- Floor guide with felt strips for glass 8 and 10 mm
- Bodenführung mit Filzgleiter für Glas 8 und 10 mm  
AN - NS

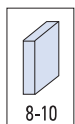

8-10

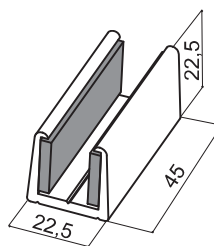

€▶A.631

FB059-A

**V-099-C dx / V-099-C sx**

- Doppia guida a pavimento destra o sinistra
- Double floor guide right or left
- Doppel Bodenführung rechts oder links  
AN

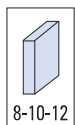

8-10-12

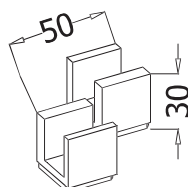

- Sinistra
- Left
- Links

- Destra
- Right
- Rechts

€▶A.633

xme425t

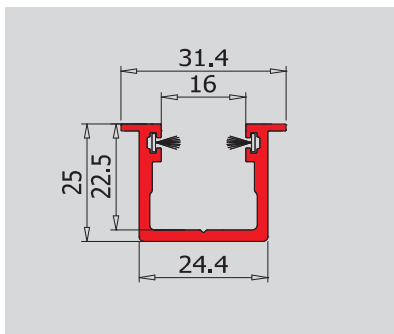
**L-116**

- Canalina da incassare a terra in alluminio compressa di spazzoline per vetro 10-12 mm
- Floor channel recessed installation with brush seals for glass 10-12 mm
- Bodenführung mit Bodenvorbereitung inkl. Bürstenprofile für Glasdicke 10-12 mm  
AN

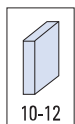

10-12

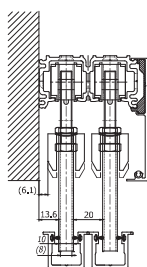

 Esempio  
Example  
Beispiel

€▶A.637

L-116

**V-053**

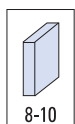
- Guida fermavetro in plastica
- Floor stopper in grey plastic
- Kunststoff-Bodenstopper, grau



8-10

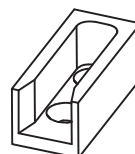

€▶A.639

V-053

175



**P-013**

- Profilino alluminio per chiusura arie scorrevole vetro mobile/vetro fisso con setola grigia, fissaggio tramite incollaggio
- Aluminium angled profile to reduce gaps between sliding door/fixed panel, with grey brush seal, to be glued on glass edge
- Aluminium Dichtungsprofil montiert auf der Glaskante

AN

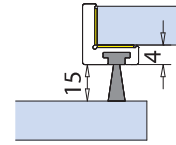
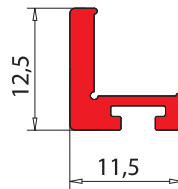
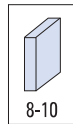

€▶ A.648

xme203-B



**P-014**

- Profilino alluminio per chiusura arie scorrevole vetro mobile/vetro fisso con spazzolino grigio, fissaggio tramite incollaggio
- Aluminium U profile to reduce gaps between sliding door/fixed panel, with grey brush seal, to be glued on glass edge
- Aluminium U Dichtungsprofil

AN

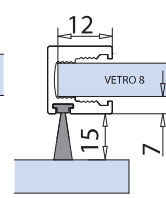
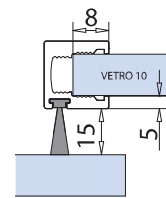
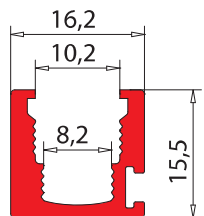
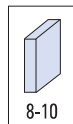

€▶ A.649

xme203-B



**WRU-S 100/60 Z**

- Guarnizione neutra per vetro 10/12 mm, fissaggio adesivo
- Neutral gasket for glass 10-12 mm with adhesive fixing
- Dichtungsprofil für 10-12 mm selbstklebend

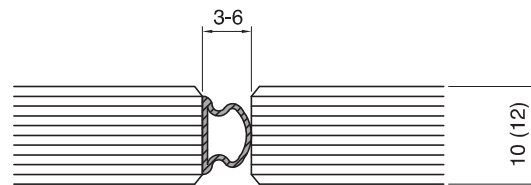
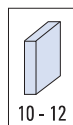

€▶ A.647

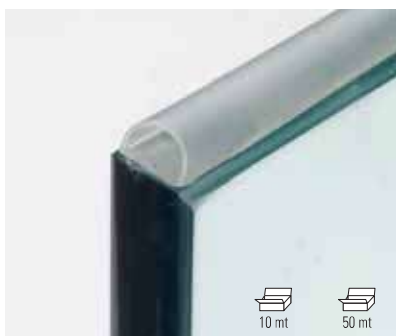

**WRU-S 60/40 R**

- Guarnizione neutra per vetro 8 mm, fissaggio adesivo
- Neutral gasket for glass 8 mm with adhesive fixing
- Dichtungsprofil für 8 mm. selbstklebend

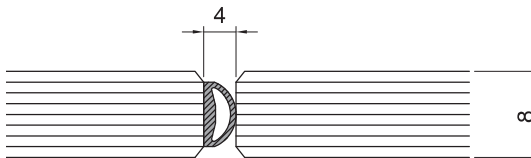
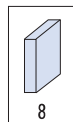

€▶ A.646



**WRU-M 80/50**

- Guarnizione neutra per vetro 8 mm, fissaggio adesivo
- Neutral gasket for glass 8 mm, with adhesive fixing
- Dichtungsprofil für 8 mm Glas, selbstklebend

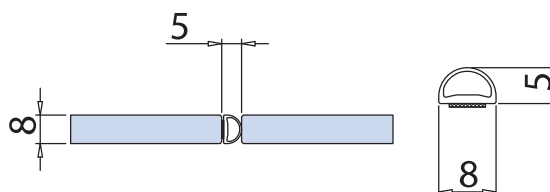
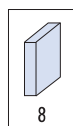

€▶ A.645

xfb-099

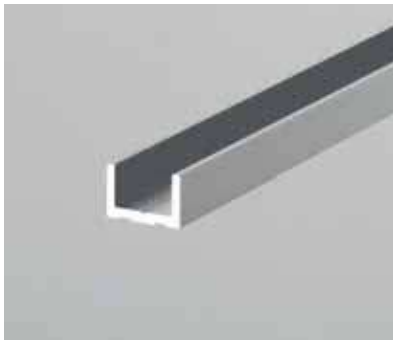

### V-2015-MIX

- Canalina per vetro fisso, comprese guarnizioni per vetro 10 mm
  - U-channel for fixed panel, gaskets included for glass 10 mm
  - U-Profil für Seitenteil, Dichtungen enthalten für Glasdicke 10 mm
- AN - IXE

#### Misura / Length / Länge

2000 mm
3000 mm
6000 mm

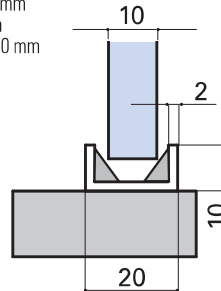

2mm

- Guarnizione nera inclusa
- Black gasket included
- Schwarze Dichtung enthalten

€▶A.641

V-2015

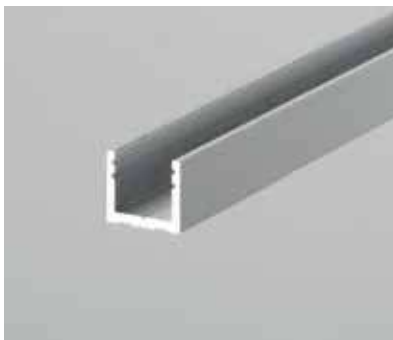

### V-2014-MIX

- Canalina per vetro fisso, escluse guarnizioni
  - U-channel for fixed panel, gaskets not included
  - U-Profil für Seitenteil, Dichtungen nicht inkl
- AN - IXE

#### Misura / Length / Länge

2000 mm
3000 mm
6000 mm

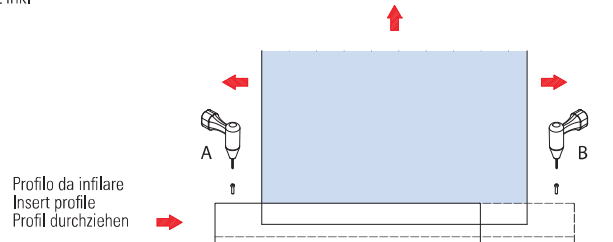
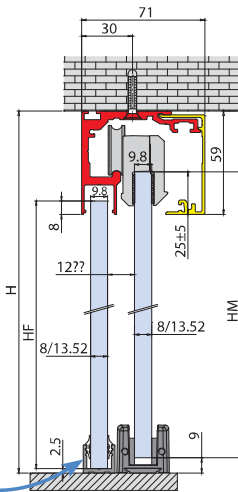
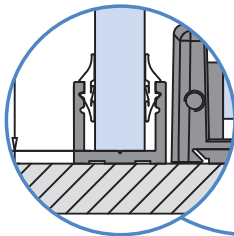

Guarnizioni  
Gaskets  
Dichtungen

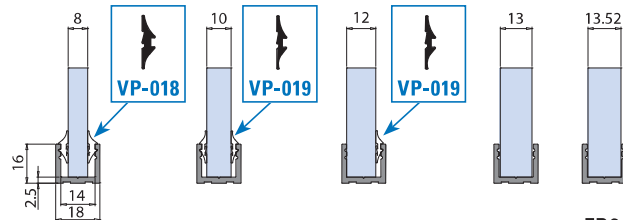

€▶A.640

FB044-E

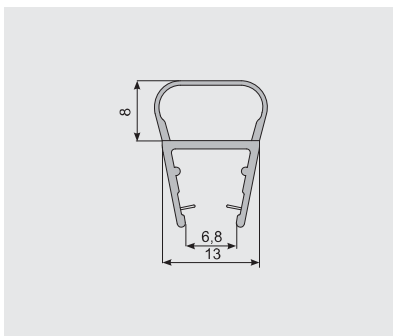

### V-041

- Guarnizione a palloncino
- Gasket
- Dichtung

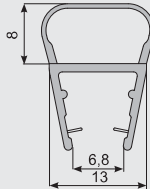

€▶A.644

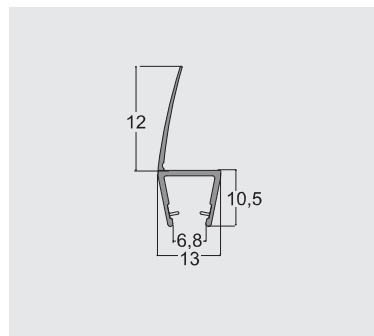

### V-039

- Guarnizione per vetro 8-10 mm
- Gasket for glass 8-10 mm
- Dichtung für Glasdicke 8-10 mm

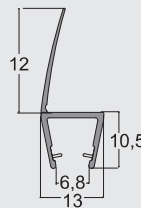

€▶A.642

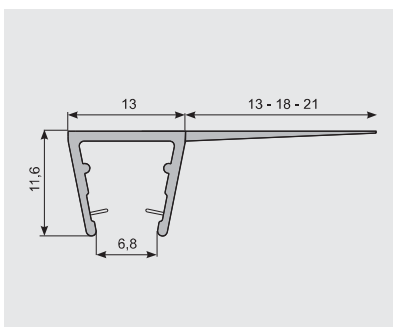

### V-040

- **ART. V-040/13**  
Guarnizione ala mm. 13  
Gasket wing mm. 13  
Dichtung mit Flügel mm. 13
- **ART. V-040/18**  
Guarnizione ala mm. 18  
Gasket wing mm. 18  
Dichtung mit Flügel mm. 18
- **ART. V-040/21**  
Guarnizione ala mm. 21  
Gasket wing mm. 21  
Dichtung mit Flügel mm. 21

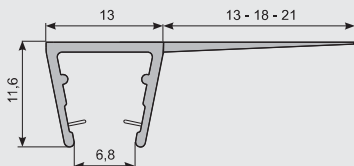

€▶A.643

