



MORSETTI COORDINATI ▶ 190
COORDINATED CLAMPS
KOORDINIERTE KLEMMEN

€ ▶ **BX.247**



B-105

- Cerniera vetro/muro apertura a tirare. Materiale: ottone.
- Glass to wall hinge, pull to open. Material: brass.
- Duschtürband Glas-Wand nach außen öffnend. Material: Messing.

CR - NS

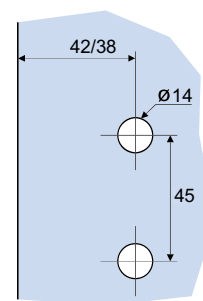
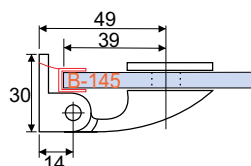
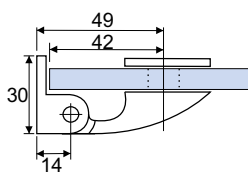
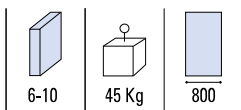
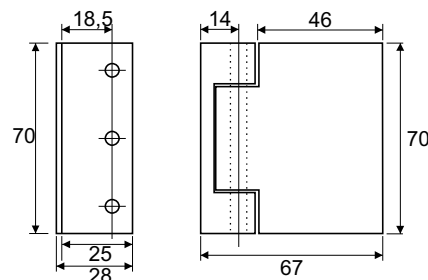

xme336



CERNIERE

€ ▶ **BX.248**



B-104

- Cerniera vetro/vetro. Materiale: ottone.
- Glass to glass hing. Material: brass.
- Duschtürband Glas-Glas. Material: Messing.

CR - NS

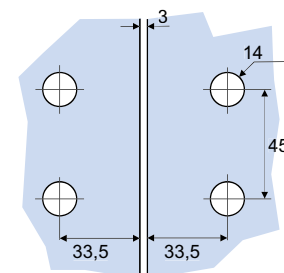
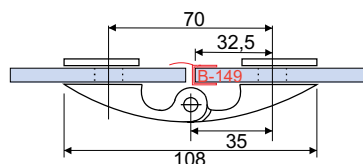
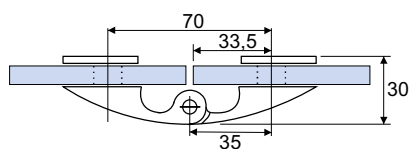
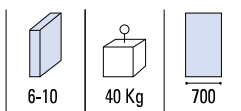
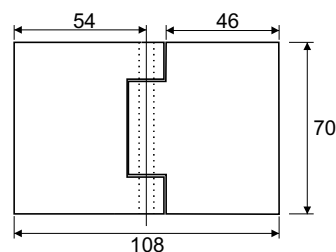

xme336

CR
Cromo lucido
Polished chrome
Chrom glänzend
148

NS
Nickel satinato
Satin nickel
Ähnlich Edelstahl matt