

EASY FRAME SEMI-VISIBLE (OPTIONAL SOFT-CLOSE)

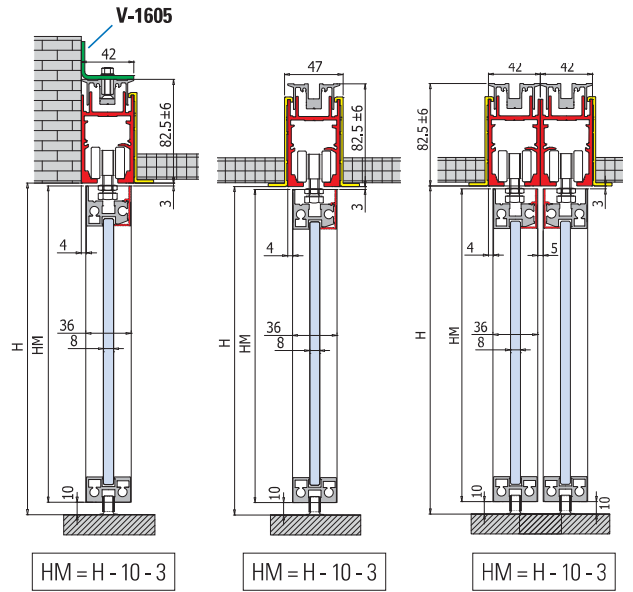

PO-290-INV

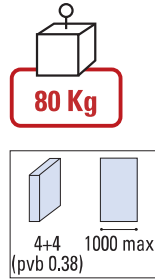

INVISIBLE

PO-290-INV SET 1

€▶A.227

- Set per 1 anta scorrevole, fissaggio a parete/soffitto
- Sliding door set, wall/ceiling installation
- Schiebetürset 1-flügelig, Wand-Deckenmontage

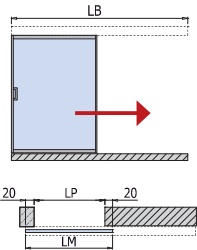

$$LB = LP \times 2 + 150$$

$$LM = LP + 40$$

PO-290-INV SET 2

€▶A.278

- Set per 2 ante scorrevoli, fissaggio a parete/soffitto
- Sliding doors set, wall/ceiling installation
- Schiebetürset 2-flügelig, Wand-Deckenmontage

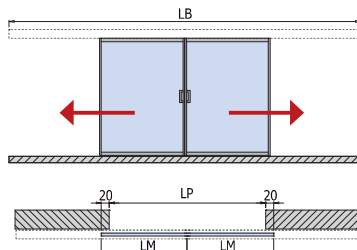

$$LB = LP \times 2 + 100$$

$$LM = (LP + 40) / 2$$

PO-290-INV SET 5

€▶A.279

- Sistema per 2 ante scorrevoli telescopiche "libere", fissaggio a soffitto
- Telescopic sliding door system 2-ways, for free movable panels, ceiling installation
- Teleskopisches Schiebetürsystem 2-läufig, frei bewegliche, gegenläufige Ganzglasschiebetüren, Deckenmontage

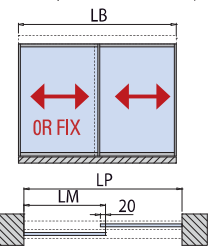

$$LB = LP$$

$$LM = (LP + 20) / 2$$

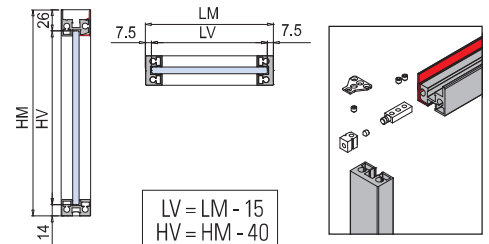
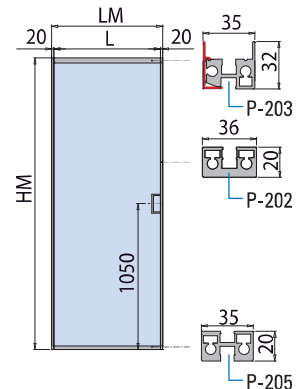

$$LV = LM - 15$$

$$HV = HM - 40$$

xme270

COMPONENTI / COMPONENTS / EINZELTEILE ▶ 89



Cod.	Fin. / Fin. / Oberf.	PO-290-INV SET 1 FIX	PO-290-INV SET 1-MIS	PO-290-INV SET 2 FIX	PO-290-INV SET 2-MIS	PO-290-INV SET 5 FIX	PO-290-INV SET 5-MIS
V-1600 L=2000 L=3000 L=4000 L=5000	AN	1	-	1	-	2	-
V-1600-MIS L=1500 R 6000	AN	-	1	-	1	-	2
PO-290	AN	1	1	2	2	2	2
V-1605 Staffa / Bracket / Winkelverbinder (OPTIONAL)	-	(1 x 400 mm)	(1 x 400 mm)	(1 x 400 mm)	(1 x 400 mm)	-	-
V-1606 Soft-close (OPTIONAL)	-	(1)	(1)	(2)	(2)	(2)	(2)
V-1608 Tappi / Endcaps / Endkappe (OPTIONAL)	AN	(1)	(1)	(1)	(1)	(2)	(2)
F-007 Maniglie / Handles / Griffe (OPTIONAL)	AN	(1)	(1)	(2)	(2)	(2)	(2)

PO-290-INV EASY FRAME SEMI-VISIBLE (OPTIONAL SOFT-CLOSE)

COMPONENTI / COMPONENTS / EINZELTEILE



V-1600
 • Binario Scorrevole
 • Track profile
 • Laufschienenprofil

€▶A.280

AN

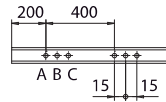

PO-292

€▶A.284

- Set accessori per 1 anta scorrevole intelaiata composto da: n.2 carrellini - n.2 stoppers - n.1 oliva a pavimento
- Accessory set for 1 sliding door with aluminium panel containing: N° 2 Carriages N° 2 stoppers N° 1 floor guide
- Zubehör Set komplett für 1 Schiebetür mit Aluminium Flügelrahmen bestehend aus: N° 2 Klemm-Laufwagen N° 2 Stopper N° 1 Bodenführung

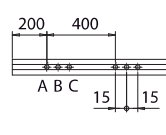
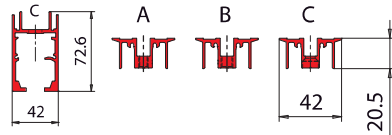

xme270

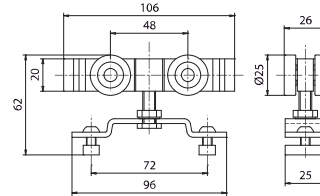
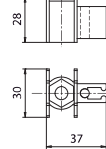

xme270



P-203
 • Traverso orizzontale superiore
 • Top horizontal profile
 • Oberes horizontalprofil
 AN

€▶A.243

€▶A.246

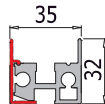

xme270a



P-202
 • Montante verticale
 • Vertical profile
 • Vertikalprofil
 AN

€▶A.242

€▶A.245

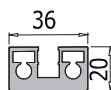

xme270a



P-205
 • Traverso orizzontale inferiore
 • Bottom horizontal profile
 • Unteres horizontalprofil
 AN

€▶A.244

€▶A.247

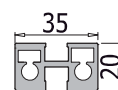

xme270a



€▶A.238

F-007

- Paio maniglie ad incollaggio in alluminio anodizzato naturale
- Pair sliding handle with self adhesive fixing in anodised aluminium
- Paar Schiebegriffe aus eloxiertem Aluminium Selbstklebend

F-007

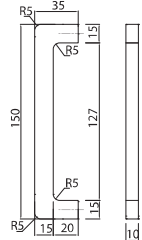

INVISIBLE



P-F25
 • Ferramenta necessaria per assemblare n.1 anta intelaiata PO-290
 • Fixing materials to assembly one aluminium panel PO-290
 • Befestigungsmaterial für 1 set Flügelrahmen PO-290

€▶A.286

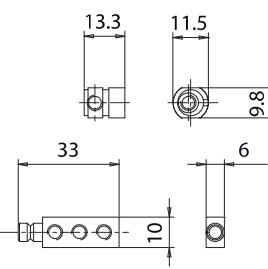
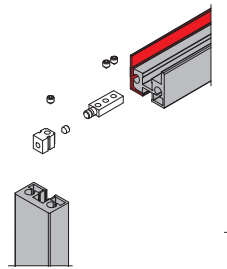

xme270

V-1605

€▶A.285

- 1 pezzo staffe per fissaggio a parete binario V-1600 (circa 1 pezzo ogni 400 mm)
- 1 Piece angle profile for wall installation track profile V-1600 (about 1 piece every 400 mm)
- 1 Stück Winkelprofil für Wandmontage Schiene V-7000 (1 Stück je ca. 400 mm)

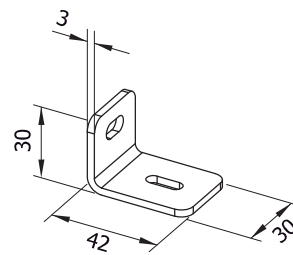
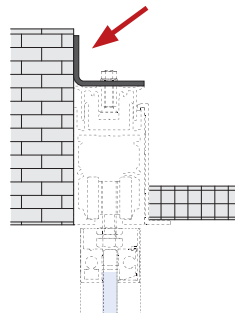

pla267b10

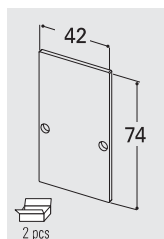

V-1608
 • Paio tappi finali per binario V-1600
 • Pair Endcaps for track profile V-1600
 • Paar Endkappen für Laufschiene V-1600
 AN

€▶A.287

2 pcs

pla267b7



V-7006
 • Profilo per montaggio binario V-1600 con appoggio per controsoffitto
 • Profil for assembly rail V-1600 with suspended ceiling
 • Profil für montage bei abgehängter Decke V-1600
 AN

€▶A.283

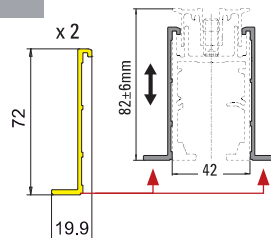

xla292b

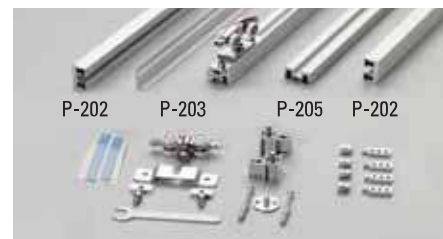

PO-290

€▶A.281

- Profili per anta intelaiata max 1200 x 3000 mm con carrelli e stopper
- Profiles for aluminium panel max 1200x3000 mm with carriages and stoppers
- Flügelrahmen aus Aluminium max 1200x3000 mm mit Laufwagen und Stopper

AN

xme270