

## EVOLUTION

### V-5100

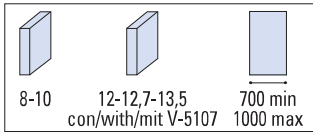

### V-5150

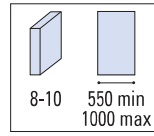

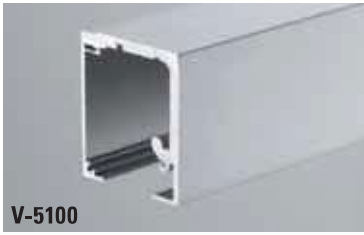
**COMPONENTI | COMPONENTS | EINZELTEILE ▶ 24**

**V-5100**

**V-5102** 120 Kg

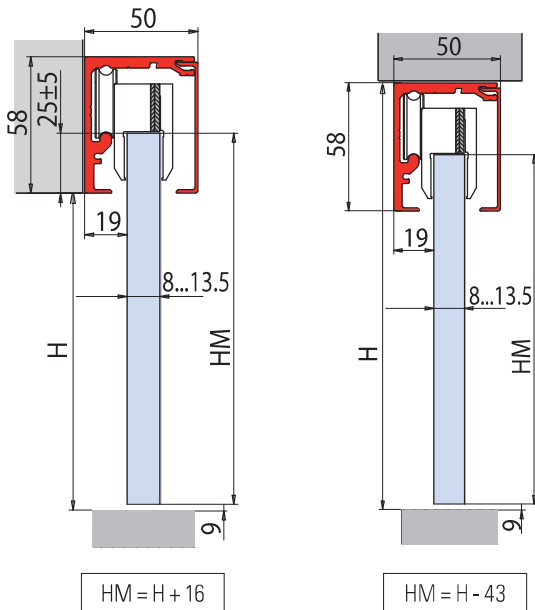
**V-5152** 70 Kg

**V-012**
**V-5101**

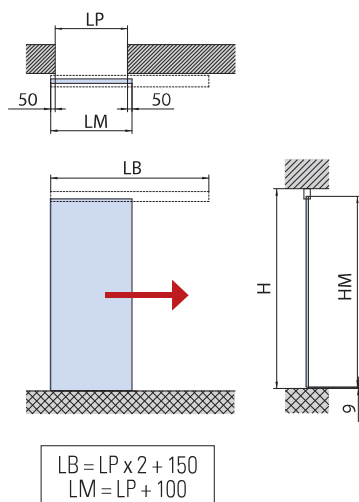
**V-5100 | V-5150 SET 1**

- Set per 1 anta scorrevole, fissaggio a parete/soffitto
- Sliding door set, wall/ceiling installation
- Schiebetürset 1-flügelig, Wand-Deckenmontage

**V-5100 | V-5150 SET 2**

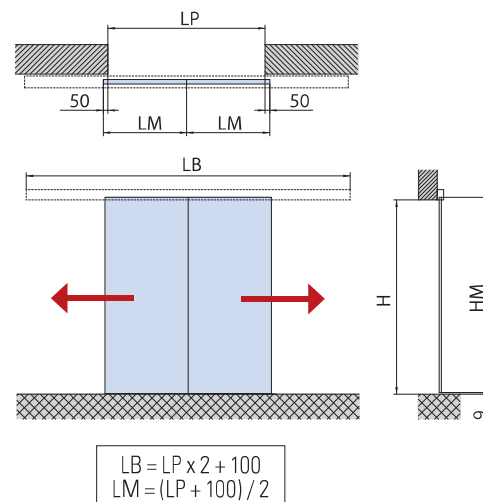
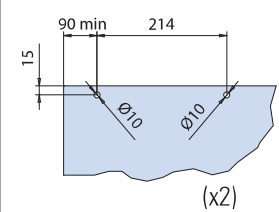
- Set per 2 ante scorrevoli, fissaggio a parete/soffitto
- Sliding doors set, wall/ceiling installation
- Schiebetürset 2-flügelig, Wand-Deckenmontage

**LAVORAZIONE VETRO  
GLASS PREPARATION  
GLASBEARBEITUNG**

- Fori optional per V-5102
- Holes optional for V-5102
- Bohrungen Optional für V-5102

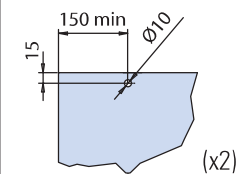

- Foro optional per V-5152
- Hole optional for V-5152
- Bohrung Optional für V-5152

xla209 / xla281c

Cod.	Fin.   Fin. Oberf.	V-5100 SET 1 FIX	V-5100 SET 1-MIS	V-5100 SET 2 FIX	V-5100 SET 2-MIS	V-5150 SET 1 FIX	V-5150 SET 1-MIS	V-5150 SET 2 FIX	V-5150 SET 2-MIS
<b>V-5100</b> L=2000 L=2500 L=3000 L=4000 L=6000	AN / IXE	1	-	1	-	1	-	1	-
<b>V-5100-MIS</b> L=1500 → 6000	AN / IXE	-	1	-	1	-	1	-	1
<b>V-5102</b>	-	1	1	2	2	-	-	-	-
<b>V-5152</b>	-	-	-	-	-	1	1	2	2
<b>V-5101</b>	AN / IXE	1	1	1	1	1	1	1	1
<b>V-012</b>	AN / NS	1	1	2	2	1	1	2	2

# V-5100 | V-5103 | V-5150 | V-5153 | V-5140 EVOLUTION

## COMPONENTI | COMPONENTS | EINZELTEILE



### V-5100

- Binario Evolution
  - Track profile Evolution
  - Laufschiene Evolution
- AN-IXE

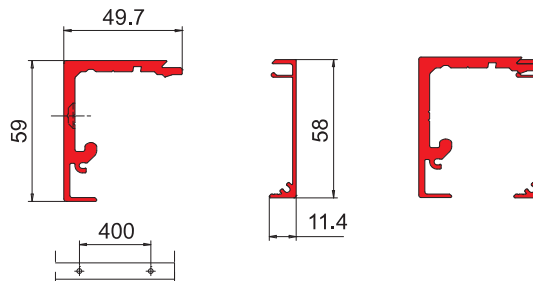

xfb-067



### V-5103

- Binario Evolution per anta scorrevole con vetro fisso laterale
  - Track profile Evolution for sliding panel and fixed side panel
  - Laufschiene Evolution für Schiebetür und Seitenteil
- AN-IXE

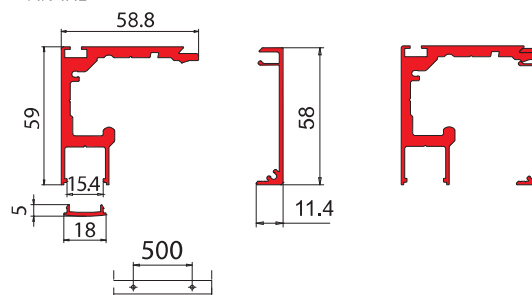

xfb-067



### V-5102

- Set accessori per 1 anta scorrevole composto da: n° 2 carrelli, morsetti per vetro 8-10 mm, n° 2 stoppers
- Accessories set for 1 sliding panel consisting of: n° 2 roller carriers for 8/10 mm glass, n° 2 stoppers
- Zubehör für 1 Schiebetür bestehend aus: n° 2 Klemm - Laufwagen für 8/10 mm Glas, n° 2 Stopper

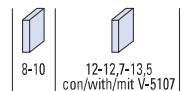
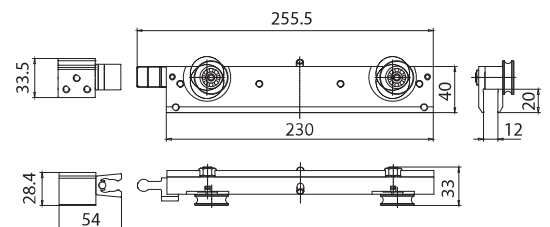

120 Kg

xme508i

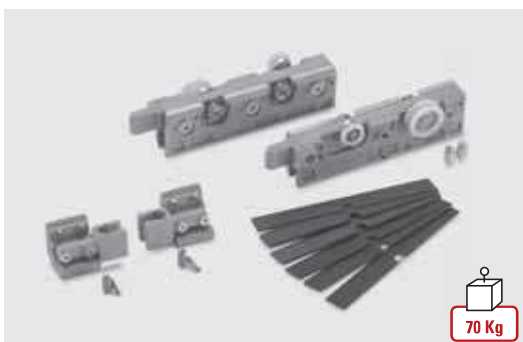

### V-5152

- Set accessori per 1 anta scorrevole composto da: n° 2 carrelli, morsetti per vetro 8-10 mm. n° 2 stoppers
- Accessories set for 1 sliding panel consisting of: n° 2 roller carriers for 8/10 mm glass, n° 2 stoppers.
- Zubehör für 1 Schiebetür bestehend aus: n° 2 Klemm - Laufwagen für 8/10 mm Glas, n° 2 Stopper

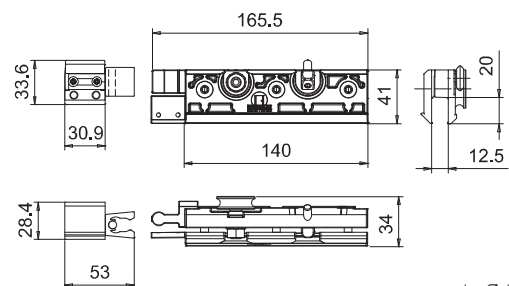

70 Kg

xme508l



**V-5006**

- Punto per fissaggio a vetro fisso della guida V-5100
- Point fitting to fix track profile V-5100 on glass
- Punktbefestigung für Glasmontage Schiene V-5100

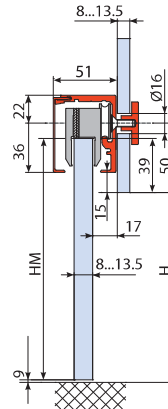
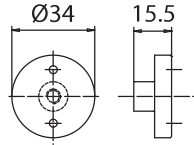
AN - IXE

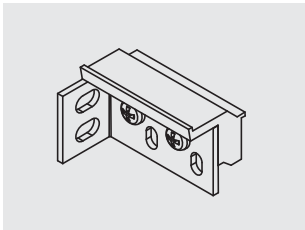

xla-211

**V-5112**

- N° 1 Staffa Evolution autoportante reversibile DX-SX per fissaggio laterale binario V-5403/muro
- 1 pcs bracket for side fixing evolution profile V-5403
- 1 Stuck winkelprofil für Seitliche Wandbefestigung Evolution Laufschiene V-5403

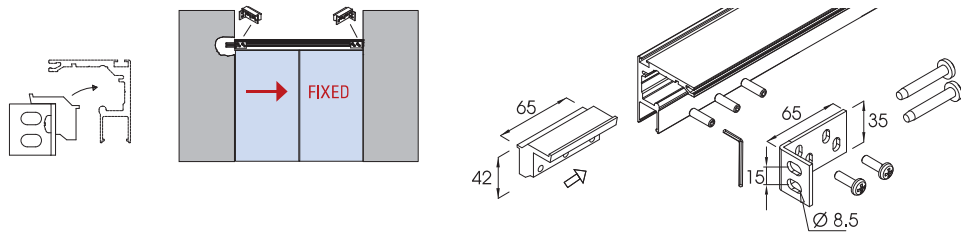

xme146

**V-5101**

- Paio tappi finali in plastica per guida a scorrimento V-5100
- Pair plastic endcaps for track profile V-5100
- Paar Endkappenn aus Kunststoff für Laufschiene V-5100

AN - IXE

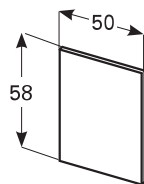

xla-209

**V-5111**

- Paio tappi finali in alluminio per guida a scorrimento V-5103
- Pair aluminium endcaps for track profile V-5103
- Paar Endkappenn aus Aluminium für Laufschiene V-5103

AN - IXE

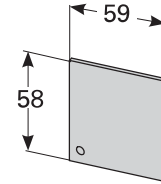

xla-209

**V-5107**

- Set per spessori vetro 12 - 12,7 - 13,5 (per 2 pinze V-5102)
- Set spacers for glass thickness 12 - 12,7 - 13,5 (for 2 clamps V-5102)
- Set distanzscheiben für Glasdicke 12 - 12,7 - 13,5 (für 2 Klemm-Lauwagen V-5102)

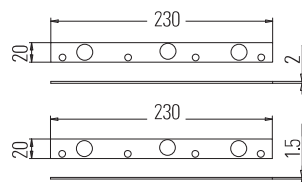
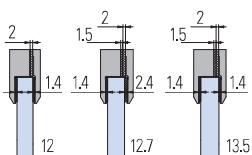

xla209b

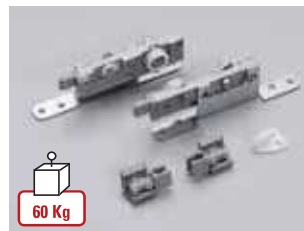
**V-5142**

- Set accessori per 1 anta scorrevole in legno composto da: 2 carrelli, morsetti per porte legno, 2 stopper
- Accessory set for 1 sliding wooden door panel consisting of 2 roller carriers for wooden door, 2 stoppers
- Zubehör komplett für 1 Holz Schiebetür bestehend aus: N° 2 Klemm - Lauwagen für Holztür, 2 Stoppers

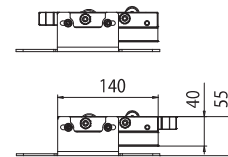
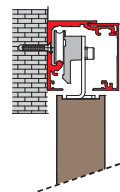

xla355

# V-5100 | V-5103 | V-5150 | V-5153 | V-5140 EVOLUTION

## COMPONENTI | COMPONENTS | EINZELTEILE



### V-5307

- Set staffe per fissaggio carrelli Evolution V-5102 con pannello legno
- Pair suspension plates hanger for Evolution clamps V-5102 with wooden doors
- Paar Winkel für Evolution Laufwagen V-5102 mit Holztüren

2 pcs

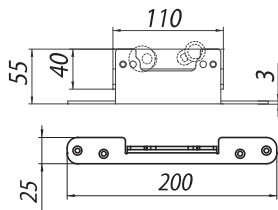

xla355



### V-5507

- Set staffe per fissaggio carrelli Evolution V-5152 con pannello legno
- Pair suspension plates hanger for Evolution clamps V-5152 with wooden doors
- Paar Winkel für Evolution Laufwagen V-5152 mit Holztüren

2 pcs

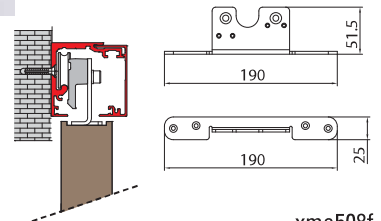

xme508f

### V-5110

- Extra montaggio kit Evolution per chiusura simultanea 2 ante. Larghezza minima anta 600 mm (senza fori di sicurezza vetro)
- Extra cost for kit 2 panels synchronously opening. Min. door width 600 mm (without security holes in glass)
- Aufpreis Set für 2 Synchron öffnende Schiebeteile. Min. Flügelbreite 600 mm (ohne Sicherheitsbohrungen in Glas)

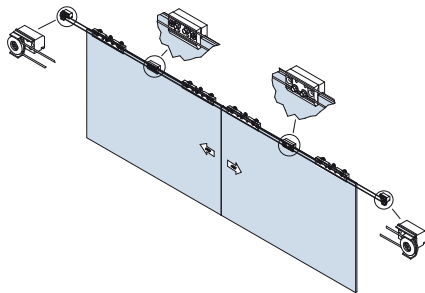

xme-094

OPTIONAL		
VP-019-MT	VP-018-MT	
2	3	
1000 mm - 2000 mm - 3000 mm		
<ul style="list-style-type: none"> <li>• Guarnizioni per sede vetro fisso</li> <li>• Gaskets for fixed glass</li> <li>• Dichtungen für Seitenteil</li> </ul>		
8	10	12