

ACCESSORI

ACCESSORIES / ZUBEHÖRE

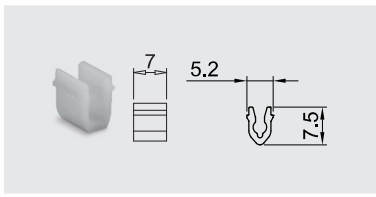

CLIP-CMR €▶ H.96

- Per vellete:
- For cover profiles:
- Für Abdeckungen:

B-8001 / B-8051 / B-8251
B-8121 / B-3501 / B-8061

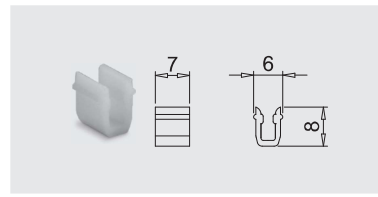

CLIPS €▶ H.95

- Per vellete:
- For cover profiles:
- Für Abdeckungen:

B-6001 / B-6051 / B-6601
B-6651 / B-2001 / B-2051
B-6201 / B-6121

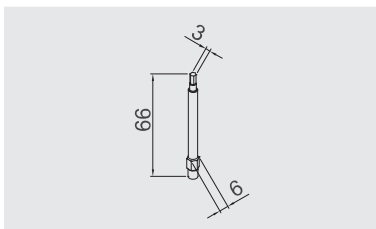

B-3509 €▶ H.201

- Inserto esagonale 3 mm per chiave a "T", fissaggio morsetti Jollypack.
- Hexagonal bit 3 mm for T-handle wrench, fixing Jollypack clamps.
- Sechskant-Schraubeinsatz 3 mm für "T" Stiftschlüssel, Jollypack Klemmen Befestigung.

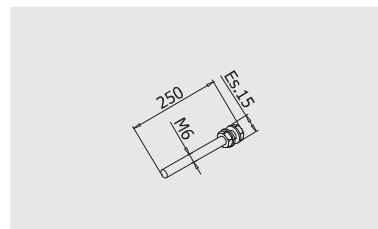

B-1055 €▶ H.202

- Vite con esagono per bilanciamento profilo nel cemento B-4050/B-2060
- Set profile screw with Hexagon for balancing Profiles B-4050/B-2060
- Set Schraube mit Sechskant für Profil Einstellung B-4050/B-2060



B-8000-DIMA €▶ H.203

- Dima per montaggio facile e veloce balaustre "CMR" (vedi video)
- Template for easy and quick installation railing system "CMR" (see video)
- Schablone für einfache und schnelle Montage Geländerprofile "CMR" (Siehe Video)



B-8000-POS €▶ H.204

- Posizionatore vetri per montaggio balaustre "CMR" (vedi video)
- Glass positioner for installation railing systems "CMR" (see video)
- Glasstellungsregler für Montage Geländerprofile "CMR" (Siehe Video)



P-F26 €▶ H.197

- Set 4 pz spine di congiunzione profili
- Set 4 pins connecting profiles
- Set 4 Stk Verbindungsstifte

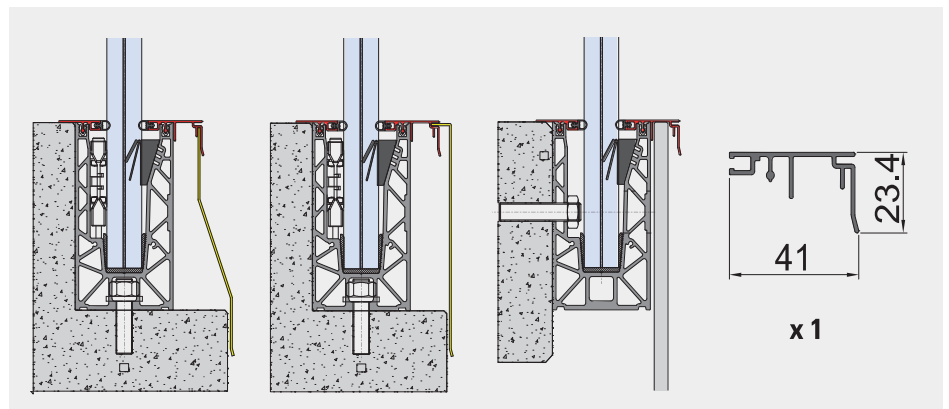
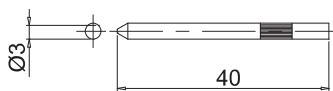

B-8061 €▶ H.93

- Vellea con sede per cartongesso o lamiera a cura del cliente
- Cover profile for plasterboard or other profiles by the customer
- Abdeckung für Gipskarton oder andere Profile bauseitig

FB041P178

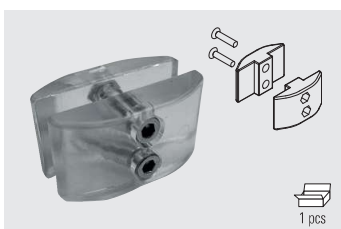

B-3115 €▶ H.209.1

- Connettore allineamento 2 vetri. Materiale: policarbonato trasparente
- Glass to glass alignment connector. Material: clear polycarbonate
- Verbinder Glas-Glas zur Ausrichtung. Material: Klares Polycarbonat

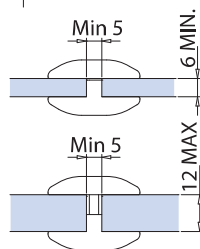

xme581

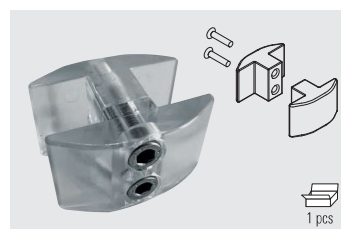

B-3116 €▶ H.209.2

- Connettore allineamento 2 vetri. Materiale: policarbonato trasparente
- Glass to glass alignment connector. Material: clear polycarbonate
- Verbinder Glas-Glas zur Ausrichtung. Material: Klares Polycarbonat

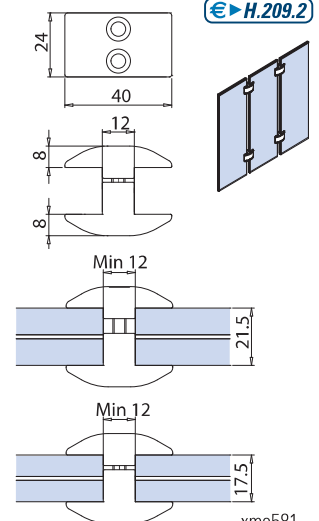

xme581