

KOMODO "H"

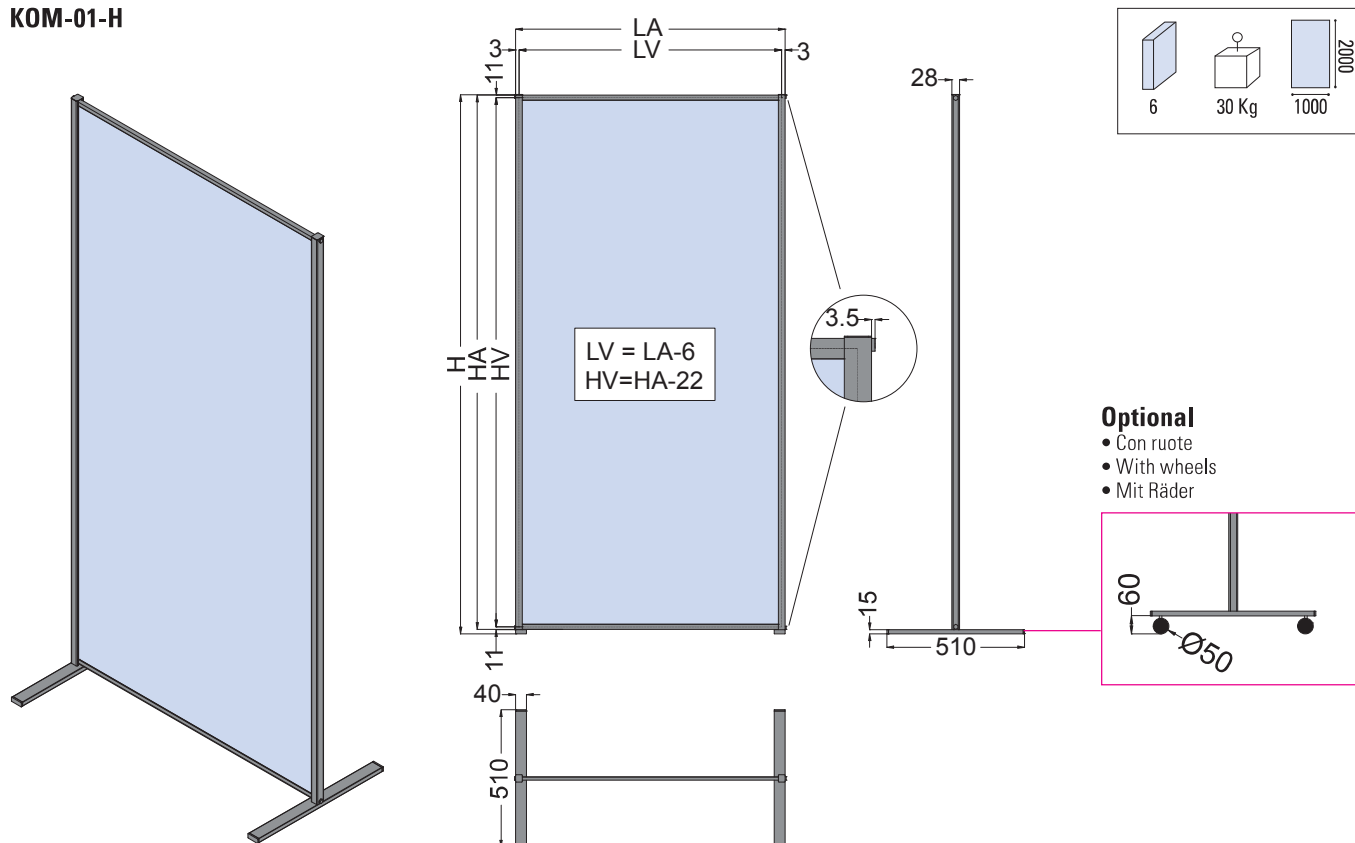

KOM-01-H

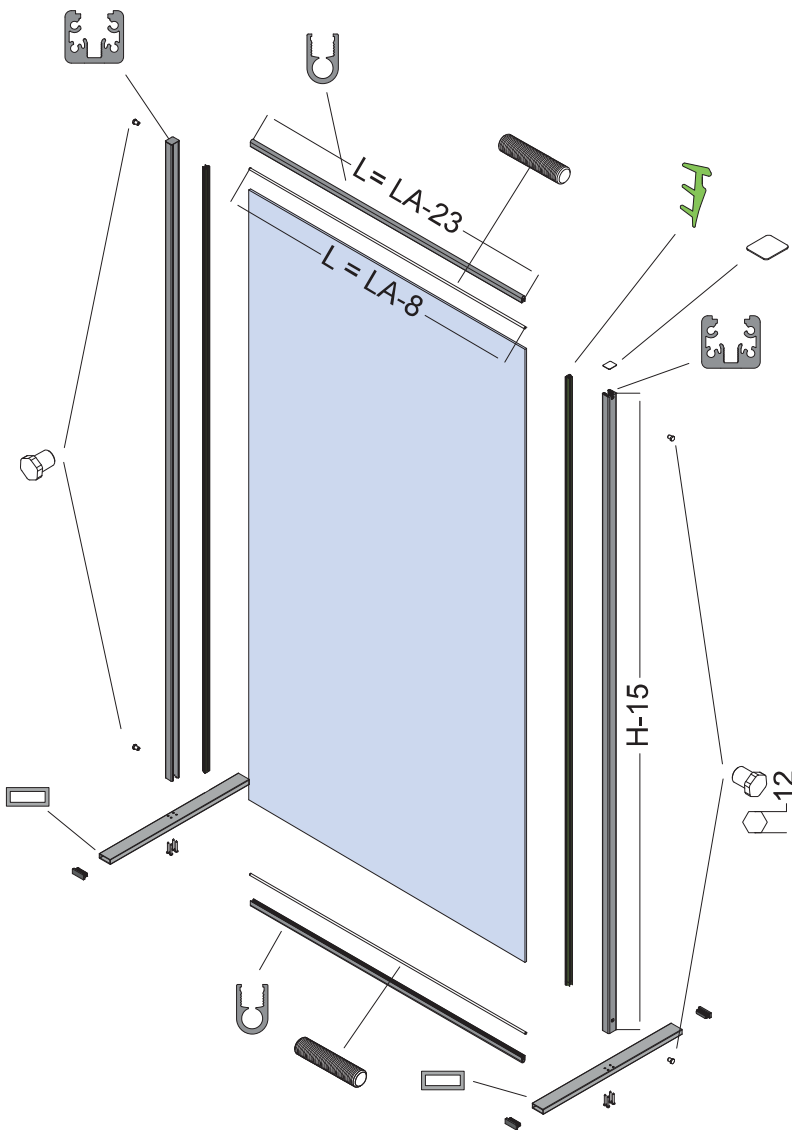



Lavorazione profili
Frames preparation
Profilbearbeitung

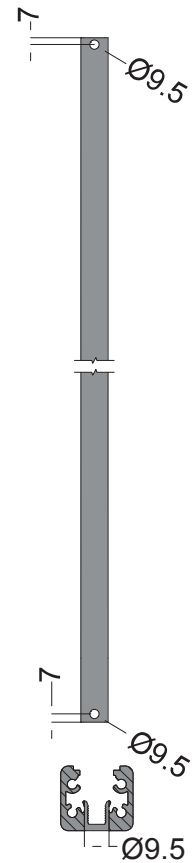

Componenti / Components / Einzelteile

<p>KOM-16</p> <ul style="list-style-type: none"> • Profilo verticale e guarnizioni • Vertical profile and gaskets • Vertikalprofil und Dichtungen 	<p>KOM-18</p> <ul style="list-style-type: none"> • Profilo orizzontale • Horizontal profile • Horizontalprofil 	<p>KOM-19</p> <ul style="list-style-type: none"> • Troncone filettato • Threaded bar • Gewindestange 	<p>KOM-20</p> <ul style="list-style-type: none"> • Set 4 boccole • Set 4 bushes • Set 4 Büchse
<p>KOM-08</p> <ul style="list-style-type: none"> • Tappo per profilo KOM • Endcap for profile KOM • Endkappe für profile KOM 	<p>KOM-21</p> <ul style="list-style-type: none"> • Set staffe tubolari • Set plates • Set Platten 	<p>SEP-02</p> <ul style="list-style-type: none"> • Set 4 ruote • Set of 4 wheels • Set mit 4 Räder 	<p>C-110 (optional)</p> <ul style="list-style-type: none"> • PVC Cristal trasparente • Transparent PVC Cristal • Klares PVC

KOMODO "H"



KOM-02-H

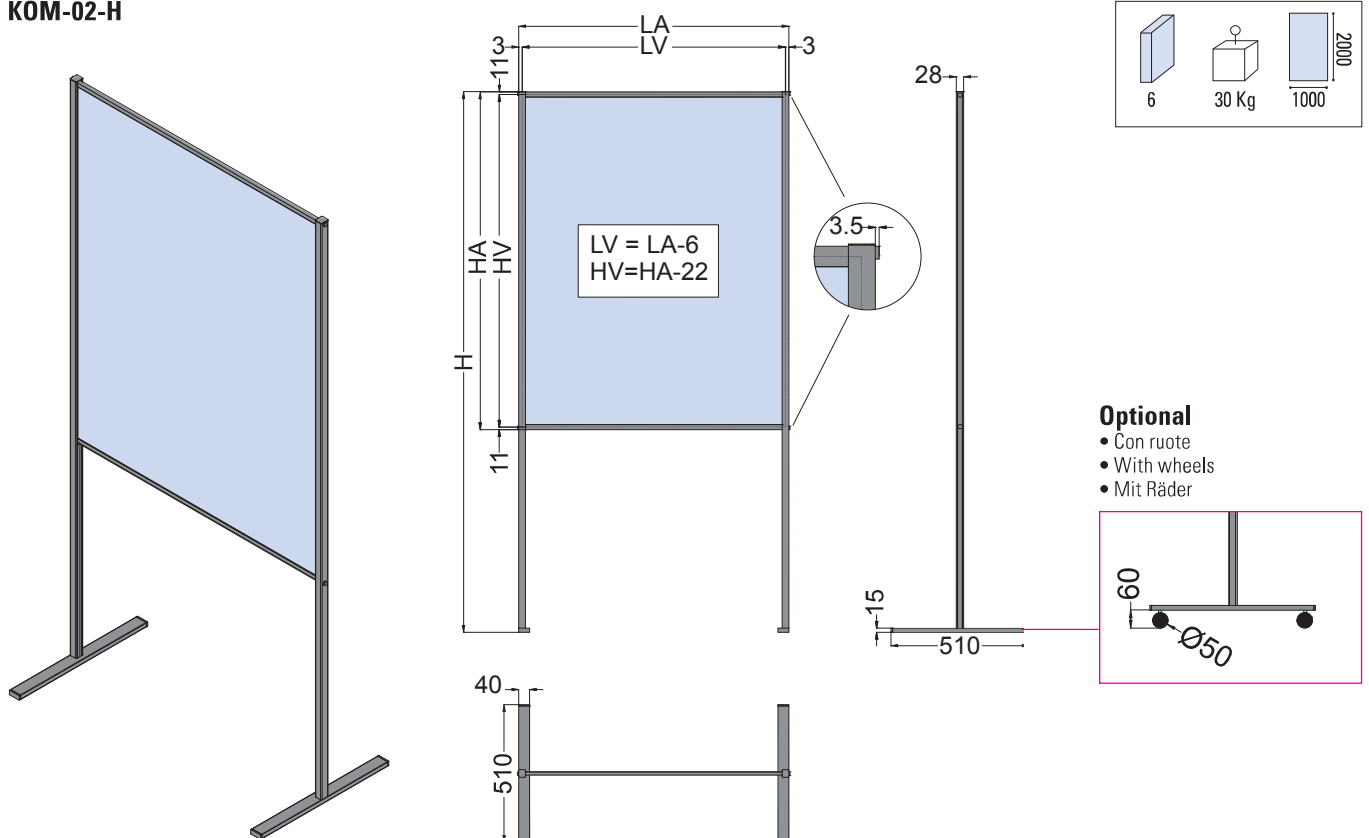

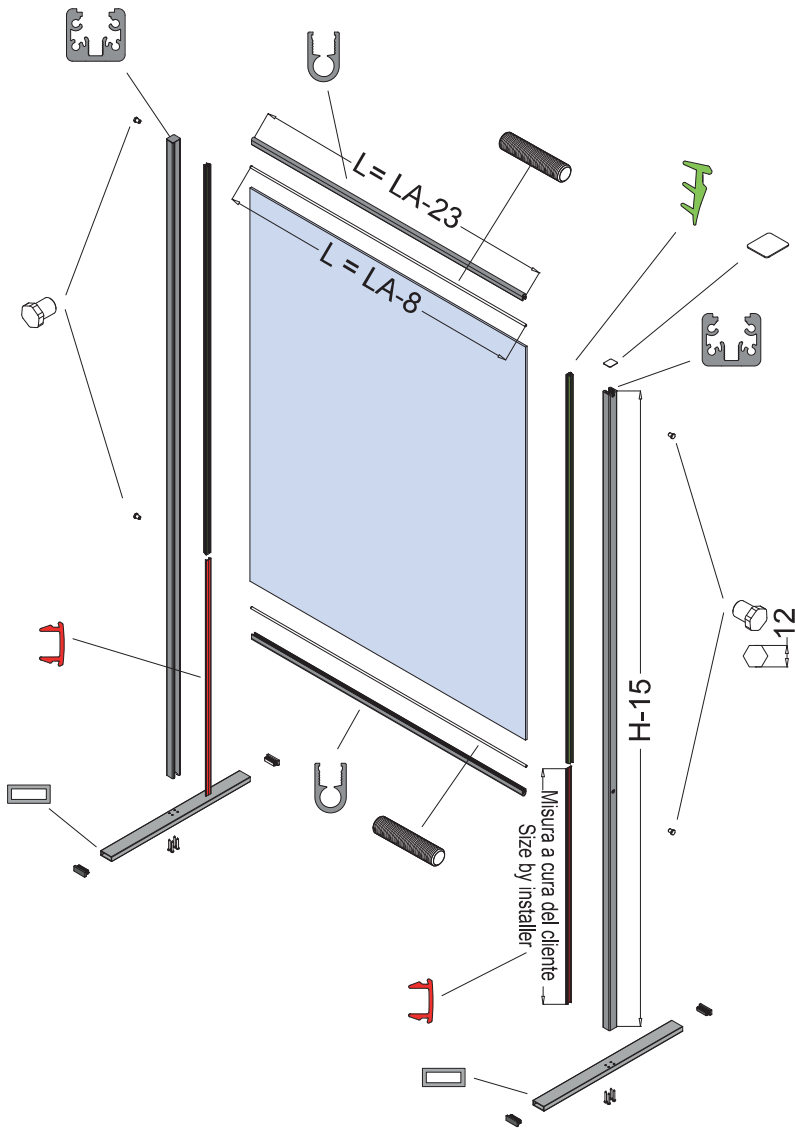

Lavorazione profili Frames preparation Profilbearbeitung

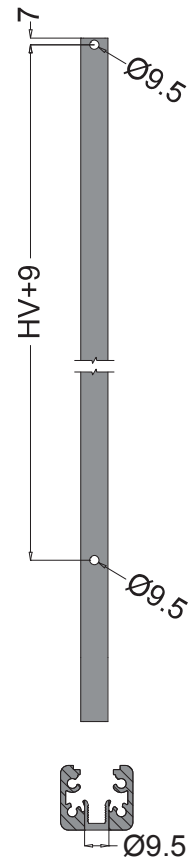

Componenti / Components / Einzelteile

KOM-16

- Profilo verticale e guarnizioni
- Vertical profile and gaskets
- Vertikalprofil und Dichtungen

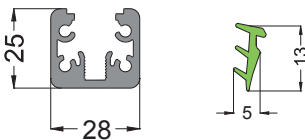
KOM-18

- Profilo orizzontale
- Horizontal profile
- Horizontalprofil

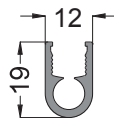
KOM-19

- Troncone filettato
- Threaded bar
- Gewindestange

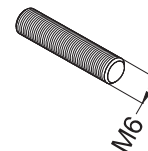
KOM-20

- Set 4 boccole
- Set 4 bushes
- Set 4 Büchse

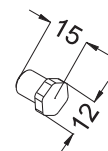
KOM-17

- Veletta
- Cover profile
- Abdeckung

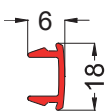
KOM-08

- Tappo per profilo KOM
- Endcap for profile KOM
- Endkappe für profile KOM

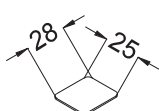
KOM-21

- Set staffe tubolari
- Set plates
- Set Platten

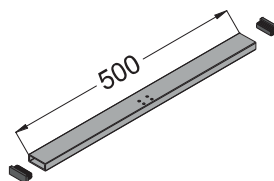
SEP-02

- Set 4 ruote
- Set of 4 wheels
- Set mit 4 Räder

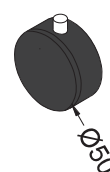
C-110 (optional)

- PVC Cristal trasparente
- Transparent PVC Cristal
- Klares PVC

