

V-807

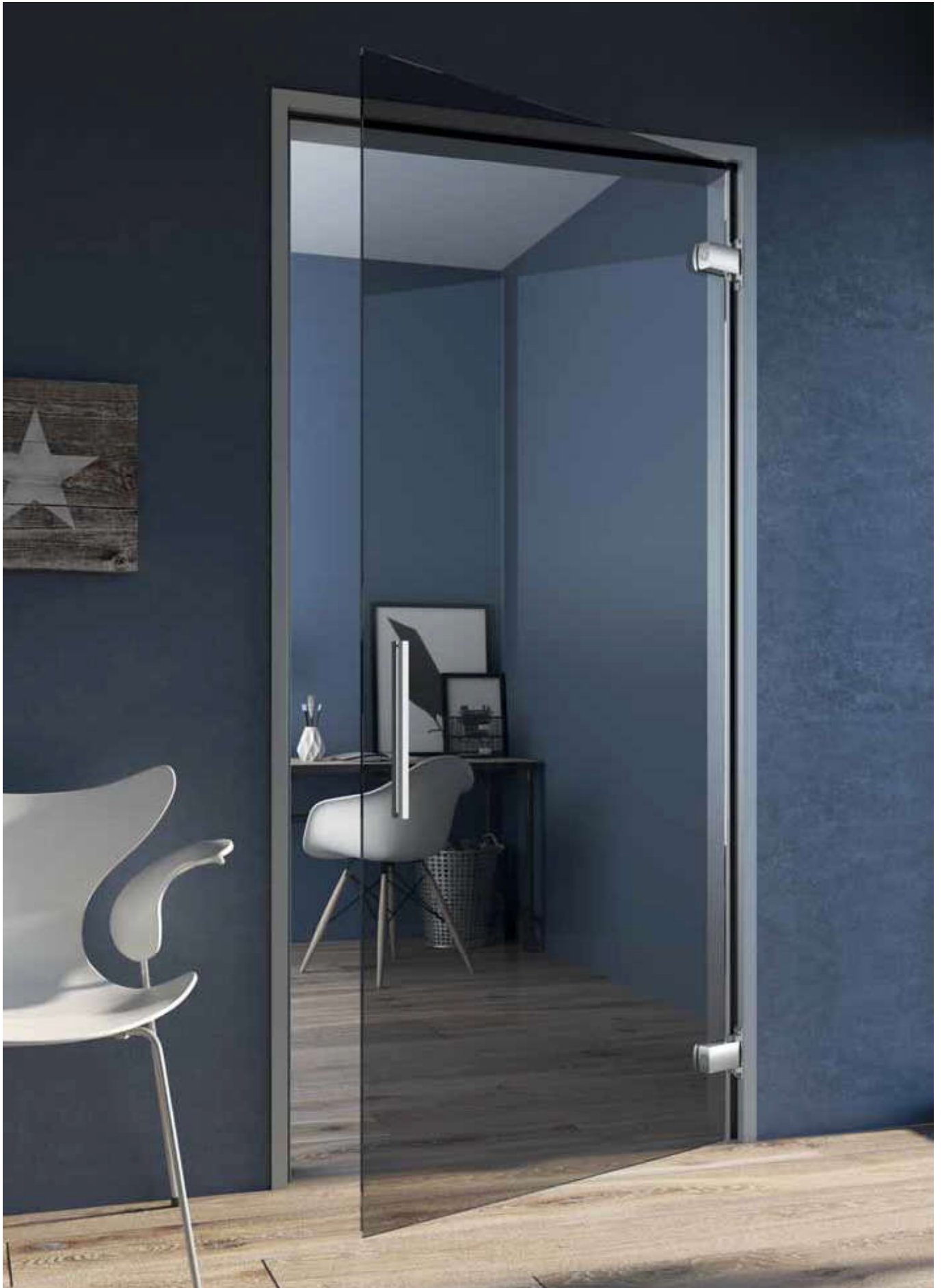

V-807 AN



- Cerniera oleodinamica con regolazione della velocità di chiusura dell'anta, per porte in battuta. Profondità stipite 40 mm. Ideale per chiusure ermetiche. Stop a 0° +90°
- Hydraulic hinge with adjustment of the closing speed glazes of the door with stop. Rebate depth 40 mm. Ideal for hermetic closing. Stop at 0° +90°.
- Automatik-Hydraulikscharnier mit Regulierung der Schließgeschwindigkeit der Tür. Für Anschlagtüren geeignet, für Falztiefe 40 mm. Ideal für hermetische Schließung Feststellung bei 0° +90°



V-807 CR € E.397



V-807 NS € E.397

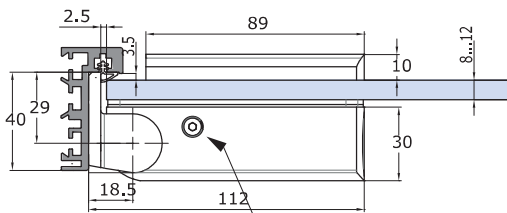
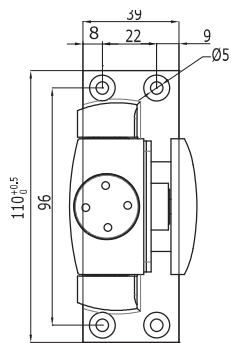

- Valvola di regolazione velocità chiusura anta
- Adjustment valve closing speed of door
- Regelsventil für die Türschließgeschwindigkeit

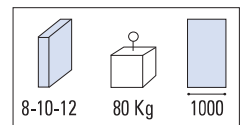
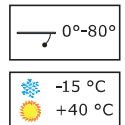
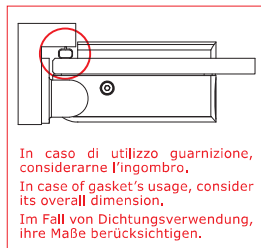
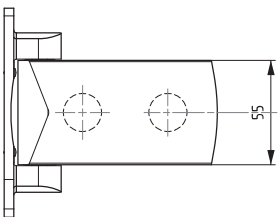
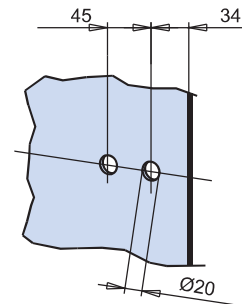

xme516

€ E.398

P-066

- Aletta optional per montaggio cerniera V-807 su stipite P-080-SL senza lavorazioni.
- Optional fixing plate for hinge V-807 for door frame P-080-SL without profile preparation.
- Optional Befestigungsplatte für Band V-807 für Anschlagtürzarge P-080-SL ohne Profilbearbeitung.

P-080-SL

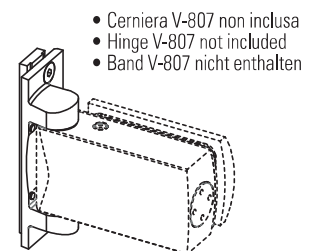
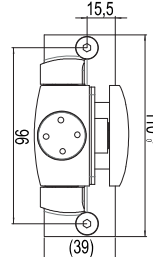
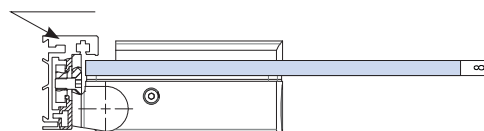

xru004

AN
Alluminio anodizzato
Aluminium anodized
Aluminium Silberfarbig

NS
Nickel satinato
Satin nickel
Ähnlich Edelstahl matt

CR
Cromo lucido
Polished chrome
Chrom glänzend