

## UNIBLOCK UB-120 + UB-122 RODS

€ H.10.1 € H.10.3

- Morsettone semiregolabile con aste. Optional supporti LED.
- Adjustable railing clamp with rods. Optional LED support.
- Verstellbare Geländerklemme mit Stangen. Optional LED Auflage.

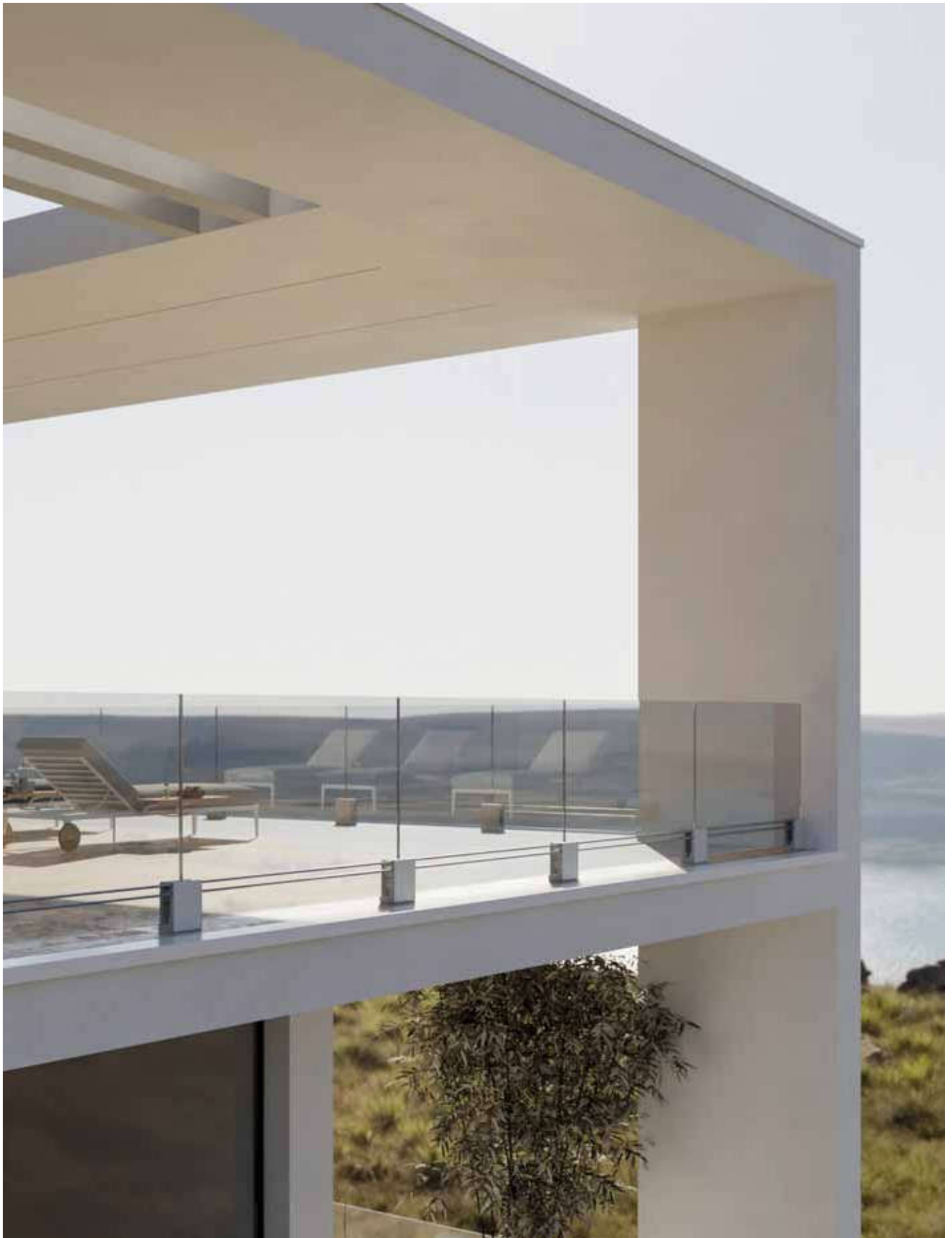

PAVIMENTO  
A PEZZI

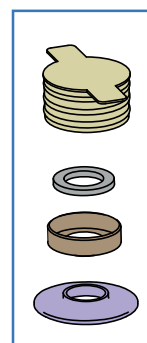
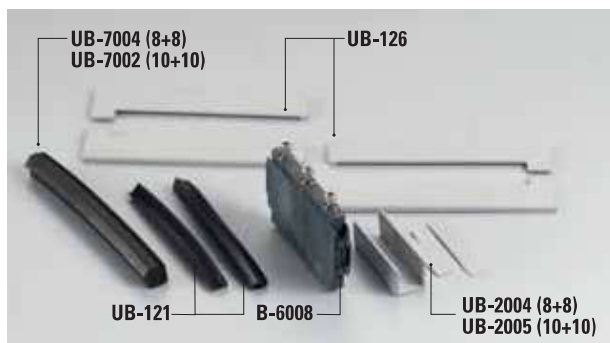

## COMPONENTI / COMPONENTS / EINZELTEILE

 PAVIMENTO  
A PEZZI

### UB-120 AG UB-120 GR

- Morsettone balastra L=120 mm
- Railing clamp L=120 mm
- Geländerklemme L=120 mm

### UB-122

- Kit di 4 aste L=3000/6000 mm
- Kit of 4 rods L=3000/6000 mm
- Kit von 4 Stangen L=3000/6000 mm

### UB-SET-120-8 UB-SET-120-10

- Set morsetti e guarnizioni
- Set clamps and gasket
- Set Klemmen und Dichtungen

### BWC-10

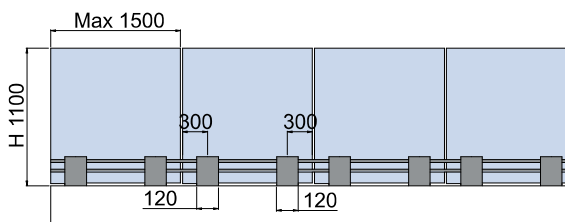
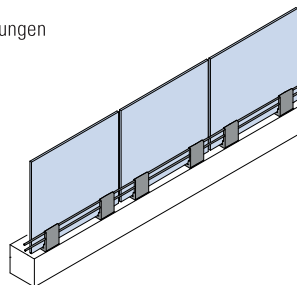
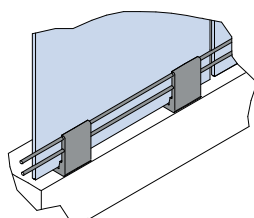
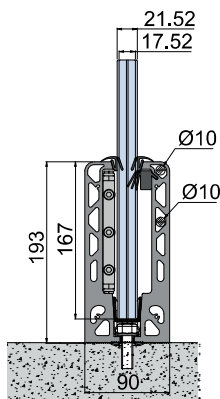
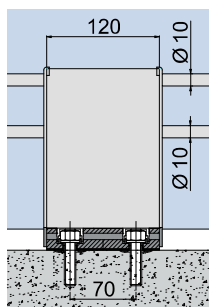

Fori tappi a cura del cliente  
Endcap holes by the customer  
Bohrungen für Endkappe Bauseits



XME573\_EDP

Set completo Complete set Komplett-Set	FIN. FIN. OB.	L=	Vetro Glass Glas	N° UB-120	Testato spinta Test side force Getestete Seitenkraft	Classe Class IT Klasse	Uni11678:2017
*UB-120 SET 1,5 KN 8	AG/GR	120 mm	8+8 PVB L=1500 mm	2	150 kg	1	1 kN/m = 100 kg/m
*UB-120 SET 3 KN 10	AG/GR	120 mm	10+10 SGP L=1500 mm	2	300 kg	2	2 kN/m = 200 kg/m
			10+10 PVB L=1000 mm	2	300 kg	2	

\* senza aste / without rods / ohne Stangen

SET COMPOSTO DA SET CONSISTING OF SET BESTEHEND AUS	FIN. FIN. OB.	UB-120 SET 1,5 KN 8 + UB-122	UB-120 SET 3 KN 10 + UB-122
UB-120	AG/GR	1	1
UB-SET-120-8	-	1	-
UB-SET-120-10	-	-	1
UB-122	AN	(1)	(1)

**AG**  
Verniciato argento / Painted silver / Silber lackiert

**GR**  
Grezzo / Raw / Roh